

**ACCESSORIES**  
**ZUBEHÖRTEILE**  
**ACCESSOIRES**



Stud Pullers & Setters  
 Stehbolzendreher  
 Extracteurs de goujons

Z-SERIES  
 HAND  
 TITANIUM  
 ACCESSORIES  
 SCREWDRIVERS  
 IMPACT  
 SLEEVE-DRIVE  
 PROTECTOR  
 INDUSTRIAL  
 AUTOMOTIVE  
 MOTORCYCLE  
 CONSTRUCTION  
 SPARE PART

**4100M / 4100A** ○ Screw and Stud Pullers  
 Stehbolzendreher  
 Extracteurs de goujons

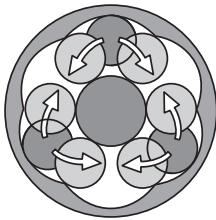
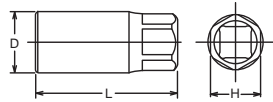

**Screw and Stud Pullers**  
 Hexagon body design can lessen the excessive load on cages and rollers inside the pullers.

**Stehbolzendreher**  
 Der neue Körper mit sechs Walzenmulden verteilt den Druck auf Käfig und Walzen weitaus vorteilhafter.

**Extracteurs de goujons**  
 Le nouveau corps de forme hexagonale répartit l'effort de façon plus uniforme sur la cage et les rouleaux.

4100M (mm)	□	D (mm)	L (mm)	H (mm)	(g)	(pcs.)	
5	1/2"	24	65	21	145	10	
6		24	65	21	150	10	
7		24	65	21	150	10	
8		24	65	21	147	10	
9		28	75	21	217	10	
10		28	75	21	213	10	
10.5		28	75	21	202	10	
11		28	75	21	218	10	
12		28	75	21	220	10	
14		34	75	27	340	5	
16		-⚠	34	75	27	315	5

4100A (inch)	□	D (mm)	L (mm)	H (mm)	(g)	(pcs.)
1/4	1/2"	24	65	21	150	10
5/16		24	65	21	147	10
3/8		28	75	21	213	10
7/16		28	75	21	218	10
1/2		28	75	21	191	10
9/16		34	75	27	340	5
5/8	-⚠	34	75	27	315	5

\* Renewal Kits → **4100MRK/4100ARK** → P307  
 ⚠ 4100M-16 and 4100A-5/8 do not have 1/2" square drive.  
 Drive the outer hexagon part with 27mm sockets or ring wrenches.  
 Die Artikel 4100M 16mm und 4100A 5/8" haben keinen 1/2" Antriebsvierkant.  
 Bitte benutzen Sie den 27mm Aussensechskant.  
 Les articles 4100M-16 et 4100A-5/8" n'ont pas de carré entraînant 1/2" , veuillez utiliser l'hexagonal 6 pans 27 mm

Tolerance			
4100M (mm)		4100A (inch)	
5	4.7- 5	1/4	6 - 6.4
6	5.6- 6	5/16	7.6- 8
7	6.6- 7	3/8	9 - 9.6
8	7.6- 8	7/16	10.5-11.1
9	8.4- 9	1/2	12.1-12.7
10	9.4-10	9/16	13.5-14.3
10.5	9.9-10.5	5/8	15.2-16
11	10.4-11		
12	11.4-12		
14	13.2-14		
16	15.2-16		

**4211M / 4211A** ○ Screw and Stud Pullers Sets  
 Stehbolzendreher im Satz  
 Jeux d'extracteurs de goujons





<b>4211M</b>	4 Pieces Set/△=1,040g
METAL CASE:W215xH80xT47mm	
PULLER	
○ 4100M Stud Pullers	
6, 8, 10, 12	
<b>4211A</b>	4 Pieces Set/△=1,040g
METAL CASE:W215xH80xT47mm	
PULLER	
○ 4100A Stud Pullers	
1/4, 5/16, 3/8, 1/2	

**4214M** ○ Screw and Stud Pullers Set  
 Stehbolzendreher im Satz  
 Jeux d'extracteurs de goujons



<b>4214M</b>	5 Pieces Set/△=1,450g
METAL CASE:W215xH80xT47mm	
PULLER	
○ 4100M Stud Pullers	
6, 8, 10, 12, 14	

6100M (mm)		D (mm)	L (mm)	H (mm)	(g)	(pcs.)
18	3/4"	48	100	36	840	1
20		48	100	36	816	1
22		48	100	36	745	1
24		48	100	36	739	1
27		63	125	46	1707	1
28		63	125	46	1701	1
29		63	125	46	1696	1
30		63	125	46	1691	1

\* Renewal Kits → 6100MRK → P307

 6100M-22 to -30 do not have 3/4" square drive.  
Drive the outer hexagon part with sockets or ring wrenches  
(size 22-24mm = 36H, 27-30mm = 46H.)  
Die Stehbolzendreher ab Abmessung 22mm haben keinen 3/4" Antriebsvierkant.  
Bitte benutzen sie den Aussensechskant.

Tolerance

6100M (mm)	Tolerance
18	16.9-18
20	18.8-20
22	20.8-22
24	22.7-24
27	25.7-27
28	26.7-28
29	27.6-29
30	28.6-30

6100M  Screw and Stud Pullers  
Stehbolzendreher  
Extracteurs de goujons

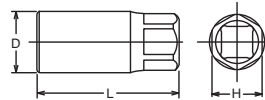

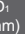
14100M (mm)		D <sub>1</sub> (mm)	D <sub>2</sub> (mm)	L (mm)	(g)	(pcs.)	
6	1/2"	24	25	48	126	10	*1
7		24	25	48	126	10	*1
8		24	25	48	122	10	*1
9		28	30	48	181	10	*2
10		28	30	48	181	10	*2
12		28	30	48	175	10	*2

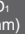
14100A (inch)		D <sub>1</sub> (mm)	D <sub>2</sub> (mm)	L (mm)	(g)	(pcs.)	
1/4	1/2"	24	25	48	126	10	*1
5/16		24	25	48	122	10	*1
3/8		28	30	48	181	10	*2
7/16		28	30	48	181	10	*2
1/2		28	30	48	180	10	*2

\*1 C-Ring=1401C, Pin/O-Ring=1401A/B → P254-255  
\*2 C-Ring=1402C, Pin/O-Ring=1402A/B

Tolerance

14100M (mm)	Tolerance	14100A (inch)	Tolerance
6	5.6- 6	1/4	6 - 6.4
7	6.6- 7	5/16	7.6- 8
8	7.6- 8	3/8	9 - 9.6
9	8.4- 9	7/16	10.5-11.1
10	9.4-10	1/2	12.1-12.7
12	11.4-12		

14100M / 14100A  IMPACT Screw and Stud Pullers  
IMPACT Stehbolzendreher  
Extracteurs de goujons IMPACT

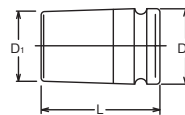

Stud Pullers & Setters  
 Stehbolzendreher  
 Extracteurs de goujons

Z-SERIES  
 HAND  
 TITANIUM  
 ACCESSORIES  
 SCREWDRIVERS  
 IMPACT  
 SLEEVE-DRIVE  
 PROTECTOR  
 INDUSTRIAL  
 AUTOMOTIVE  
 MOTORCYCLE  
 CONSTRUCTION  
 SPARE PART

**141S / 141** Stud Puller Ratchets  
 Stehbolzensausdreher-Knarren  
 Dégoujoneuses à cliquet



141S (mm)	D (mm)	L (mm)	(g)	(pce.)
6	28	120	150	1
8	28	120	150	1
10	32	120	153	1
12	32	120	152	1

141S (inch)	D (mm)	L (mm)	(g)	(pce.)
5/16	28	120	150	1
3/8	32	120	153	1
1/2	32	120	152	1

141 (mm)	D (mm)	L (mm)	(g)	(pce.)
6	28	205	215	1
8	28	205	215	1
10	32	205	234	1
12	32	205	233	1

141 (inch)	D (mm)	L (mm)	(g)	(pce.)
5/16	28	205	215	1
3/8	32	205	234	1
1/2	32	205	233	1

**141P** Stud Puller Ratchets  
 Stehbolzensausdreher-Knarren  
 Dégoujoneuses à cliquet

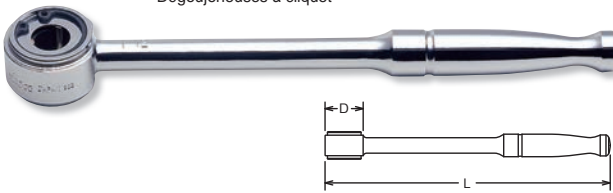

141P (mm)	D (mm)	L (mm)	(g)	(pce.)
6	28	205	210	1
8	28	205	210	1
10	32	205	229	1
12	32	205	227	1

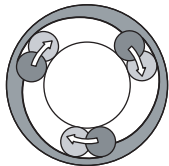

The three roller system can protect the studs from damage.  
 Das Drei-Rollen-System schützt die Stehbolzen.  
 Le système à trois roulettes n'endommage pas les goujons.



**1201** Stud Puller Ratchets  
 Stehbolzensausdreher-Knarren  
 Dégoujoneuses à cliquet



1201 4 Pieces Set/△=973g  
 METAL CASE:W240xH100xT32mm  
 PULLER  
 141S Stud Puller Ratchet  
 6, 8, 10, 12

**4104** Screw and Stud Puller  
 Stehbolzendreher  
 Extracteur de goujons



4104	□	Tolerance		D (mm)	L (mm)	(g)	(pcs.)
		min	max				
	1/2	φ 6	φ 19	54	56	489	2



4103M (mm)		D <sub>1</sub> (mm)	D <sub>2</sub> (mm)	H (mm)	L (mm)	 (g)	 (pcs.)
6(1.0)	1/2"	10.3	22	9	37	54	10
7(1.0)		11.5	22	10	37	58	10
8(1.25)		13.2	22	11	37	60	10
10(1.25)		15.3	23	13	44	86	10
10(1.5)		15.3	23	13	44	86	10
12(1.25)		17.8	23	14	44	86	10
12(1.75)		17.8	23	14	44	86	10

Depend on the stud bolt and using torque, 4103M/13103M/14103M may cause a scratch against the stud bolts or got stuck itself during a work.



### 4103M Stud Bolt Setters Stehbolzensetzer Monte-goujons

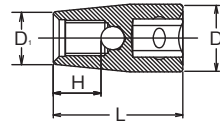

**4203M** 4 Pieces Set/ =530g  
METAL CASE:W130xH65xT26mm  
Stud Bolt Setter

**4103M** Stud Bolt Setters  
6(1.0), 8(1.25), 10(1.5), 12(1.75)

**4203MF** 4 Pieces Set/ =530g  
METAL CASE:W130xH65xT26mm  
Stud Bolt Setter

**4103M** Stud Bolt Setters  
6(1.0), 8(1.25), 10(1.25), 12(1.25)

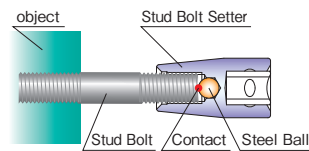

A special socket for installing a stud bolt.  
Inside steel ball prevents the stud bolt stuck onto the socket. After installing a stud bolt, turn to anti-clockwise to removing the socket.

Spezialwerkzeug zum Setzen von Stehbolzen. Der Bolzen trifft im Werkzeug nur auf die gehärtete Stahlkugel, was die Kontaktfläche verringert. Nach dem Setzen des Stehbolzens kann das Werkzeug im Linkslauf vom Stehbolzen abgezogen werden.

Douilles spéciales pour monter les goujons.  
Le goujon est en contact avec une bille d'acier pour l'empêcher d'adhérer à la douille.  
Après avoir posé le goujon, tourner dans le sens antihorlogique pour le retirer

### 4203M Stud Bolt Setters Set Stehbolzensetzer im Satz 4203MF Jeu de monte-goujons



13103M (mm)		D <sub>1</sub> (mm)	D <sub>2</sub> (mm)	H (mm)	L (mm)	 (g)	 (pcs.)	
5(0.8)	3/8"	9.5	19	8	32	39	10	*1
6(1.0)		10.8	19	9	32	41	10	*1
7(1.0)		12.5	19	10	32	44	10	*1
8(1.25)		13.5	19	11	35	49	10	*1
10(1.25)		15.8	19	13	35	49	10	*1
10(1.5)		15.8	19	13	35	49	10	*1

\*1 C-Ring=1301C, Pin/O-Ring=1301A/B P254-255

Depend on the stud bolt and using torque, 4103M/13103M/14103M may cause a scratch against the stud bolts or got stuck itself during a work.

### 13103M Impact Stud Bolt Setters Impact Stehbolzensetzer Monte-goujons Impact

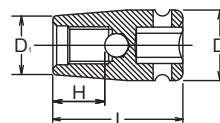

14103M (mm)		D <sub>1</sub> (mm)	D <sub>2</sub> (mm)	H (mm)	L (mm)	 (g)	 (pcs.)	
6(1.0)	1/2"	12	25	11	42	75	10	*1
7(1.0)		13.2	25	12	42	78	10	*1
8(1.25)		14.5	25	15	42	81	10	*1
10(1.25)		17	25	18	49	106	10	*1
10(1.5)		17	25	18	49	106	10	*1
12(1.25)		19.5	25	19	49	107	10	*1
12(1.75)		19.5	25	19	49	107	10	*1
14(1.5)	22	25	21	55	128	10	*1	
14(2.0)	22	25	21	55	128	10	*1	

\*1 C-Ring=1401C, Pin/O-Ring=1401A/B P254-255

Depend on the stud bolt and using torque, 4103M/13103M/14103M may cause a scratch against the stud bolts or got stuck itself during a work.

### 14103M Impact Stud Bolt Setters Impact Stehbolzensetzer Monte-goujons Impact

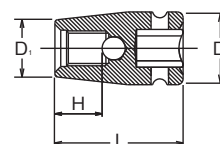

Z-SERIES  
HAND  
TITANIUM  
ACCESSORIES  
SCREWDRIVERS  
IMPACT  
SLEEVE-DRIVE  
PROTECTOR  
INDUSTRIAL  
AUTOMOTIVE  
MOTORCYCLE  
CONSTRUCTION  
SPARE PART

Tap Holder / Die Holder  
 Halter für Gewindeschneider / Halter für Gewindeschneideisen  
 Porte taraud / Porte-filière

Z-SERIES  
 HAND  
 TITANIUM  
 SCREWDRIVERS ACCESSORIES  
 IMPACT  
 SLEEVE-DRIVE  
 PROTECTOR  
 INDUSTRIAL  
 AUTOMOTIVE  
 MOTORCYCLE  
 CONSTRUCTION  
 SPARE PART

**3131E** Tap Holder  
 Halter für Gewindeschneider  
 Porte taraud / porte-filière

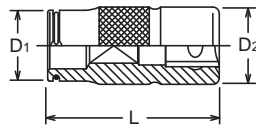

	3131E	□	D <sub>1</sub> (mm)	D <sub>2</sub> (mm)	L (mm)	⚖️ (g)	📦 (pcs.)
New	□ 2.1x ø2.8	3/8"	6.8	18	40	45	10
New	□ 2.7x ø3.5		8	18	40	46	10
New	□ 3.4x ø4.5		9.5	18	40	47	10
New	□ 4.9x ø6		11.5	18	40	48	10
New	□ 5.5x ø7		12.5	18	40	49	10
New	□ 7 x ø9		15	18	40	48	10
New	□ 9 x ø11		17	18	40	48	10
New	□ 9 x ø12		18	18	40	48	10

For DIN352, DIN351, DIN2181, DIN5157 tap

**3264** Tap Holder set 10 pieces  
 Halter für Gewindeschneider im Satz  
 Jeu de portes taraud



New 3264		10 Pieces Set/⚖️=1.050g	
METAL CASE:W240xH100xT32mm			
Sockets		Accessories	
📦	<b>3131E</b>		<b>160K</b>
	□ 2.1xø2.8, □ 2.7xø3.5,		
	□ 3.4xø4.5, □ 4.9xø6,		
	□ 5.5xø7, □ 7xø9,		
	□ 9xø11, □ 9xø12,		
			<b>3760-125</b>

**3131A** Adjustable Tap Holder  
 Halter für Gewindeschneider, einstellbar  
 Porte taraud, ajustable

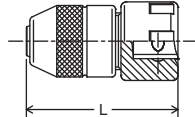

3131A	□	S(mm)		L (mm)	⚖️ (g)	📦 (pcs.)
		Min.	Max.			
1	3/8"	2.0	5.0	42	80	5
2		4.5	8.0	47	100	5

S(mm)

Min.

Max.

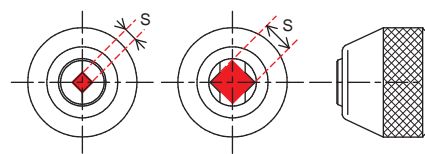

**160K** Reversible Ratchet  
 Verstellbare Knarre  
 Cliquet réversible

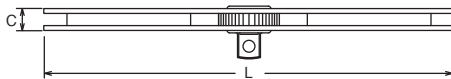

Tap is not included.  
 Gewindeschneider, nicht enthalten.  
 Taraud non inclus.

	□	C (mm)	L (mm)	⚖️ (g)	📦 (pce.)
<b>160K</b>	3/8"	10	220	130	1
<b>160K-1/2</b>	1/2"	10	220	135	1

**3132** Die Holder  
 Halter für Gewindeschneideisen  
 Porte-filière

**4132**

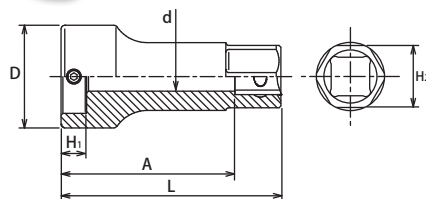

	□	D (mm)	H <sub>1</sub> (mm)	H <sub>2</sub> (mm)	d (mm)	A (mm)	L (mm)	⚖️ (g)	📦 (pcs.)
<b>3132-20</b>	3/8"	28	7	17	8	45	60	130	5
<b>4132-25</b>		34	9	22	14	40	60	170	2
<b>4132-38</b>	1/2"	48	13	24	18	60	80	315	2
<b>4132-50</b>		60	16	27	30	85	105	740	2



Die is not included.  
 Gewindeschneideisen, nicht enthalten.  
 Filière non inclus.

2127 (mm)		D <sub>1</sub> (mm)	D <sub>2</sub> (mm)	H (mm)	L (mm)	(g)	(pcs.)
4	1/4"	7	13	4	23	14	10
4.5		7.4	13	4	23	14	10
5		8	13	5	23	14	10
5.5		8.8	13	5	23	14	10
6		9.5	13	6	23	14	10
7		10.9	13	6	23	14	10
8		11.5	13	8	23	14	10
9		13	13	8	23	15	10
9.5		13.8	13	10	23	16	10
10		14.8	13	10	23	17	10



**2127** NUTTWISTER®

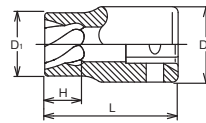

RS2127/6	6 Pieces Set/Rail 150mm	(g)
4, 4.5, 5, 5.5, 6, 7		105

**RS2127/6** Socket Set on Rail  
Steckschlüsselsatz auf Schiene  
Jeu de douilles sur rail

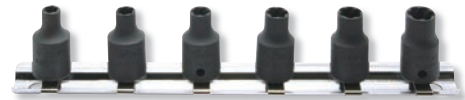

RS2127/10	10 Pieces Set/Rail 150mm	(g)
4, 4.5, 5, 5.5, 6, 7, 8, 9, 9.5, 10		180

**RS2127/10** Socket Set on Rail  
Steckschlüsselsatz auf Schiene  
Jeu de douilles sur rail



3127 (mm)		D <sub>1</sub> (mm)	D <sub>2</sub> (mm)	H (mm)	L (mm)	(g)	(pcs.)
8	3/8"	11.5	19	8	32	40	10
9		13	19	8	32	40	10
9.5		13.8	19	8	32	41	10
10		14.8	19	10	32	41	10
11		16	19	10	32	43	10
12		17	19	12	32	44	10
13		18.5	19	12	32	46	10
14		19.7	19	14	32	48	10
15		20.7	19	14	32	52	10
16		22.2	22	14	32	66	10
17	23.5	22	16	35	80	10	
19	26	22	16	35	92	10	

**3127** NUTTWISTER®

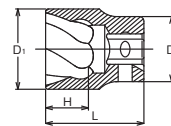

RS3127/8	8 Pieces Set/Rail 200mm	(g)
8, 9, 10, 11, 12, 13, 14, 16		420

**RS3127/8** Socket Set on Rail  
Steckschlüsselsatz auf Schiene  
Jeu de douilles sur rail



3128-80 (mm)		D <sub>1</sub> (mm)	D <sub>2</sub> (mm)	H (mm)	L (mm)	(g)	(pcs.)
8	3/8"	11.5	19	6	80	58	10
9		13	19	6	80	61	10
10		14.8	19	8	80	66	10
11		16	19	8	80	70	10
12		17	19	10	80	77	10
13		18.5	19	10	80	80	10
14		19.7	19	12	80	82	10

**3128 (L80)** NUTTWISTER® (Long type)

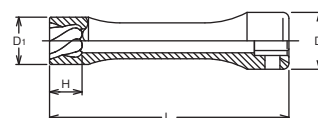

Z-SERIES  
HAND  
TITANIUM  
ACCESSORIES  
SCREWDRIVERS  
IMPACT  
SLEEVE-DRIVE  
PROTECTOR  
INDUSTRIAL  
AUTOMOTIVE  
MOTORCYCLE  
CONSTRUCTION  
SPARE PART

**4127**  NUTTWISTER®

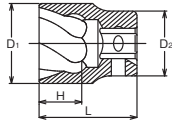

4127 (mm)		D <sub>1</sub> (mm)	D <sub>2</sub> (mm)	H (mm)	L (mm)	(g)	(pcs.)
14	1/2"	19.7	30	14	42	125	10
17		23.5	30	16	42	137	10
19		26	30	16	42	146	10
21		28	30	17	42	153	10
22		29.5	30	17	42	158	10
24		32	30	18	42	174	10
25.4		33.5	30	18	42	183	10

**RS4127/6**   Socket Set on Rail  
Steckschlüsselsatz auf Schiene  
Jeu de douilles sur rail



RS4127/6	6 Pieces Set/Rail 200mm	(g)
17, 19, 21, 22, 24, 25.4		960

**4128 (L120)**  NUTTWISTER® (Long type)

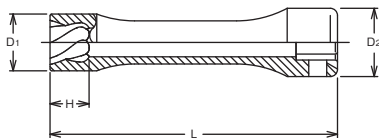

4128-120 (mm)		D <sub>1</sub> (mm)	D <sub>2</sub> (mm)	H (mm)	L (mm)	(g)	(pcs.)
17	1/2"	23.5	30	16	120	227	10
19		26	30	16	120	247	10
21		28	30	17	120	262	10
22		29.5	30	17	120	259	10

A very effective method and easy solution for removing rounded off nuts, bolts and studs. The sharp edges of the NUTTWISTER® Socket opening will tighten around the nut, bolt or stud and turn it easily off.

Eine einfache und wirkungsvolle Methode rund gedrehte Muttern und Bolzen herausdrehen bzw. zu öffnen.  
Die scharfen Kanten der gewundenen NUTTWISTER® Öffnung setzen sich um die Mutter bzw. den Schraubenkopf und drehen sie problemlos heraus.

Il existe une méthode simple mais efficace pour retirer les écrous et les boulons arrondis ainsi que les goujons et les dispositifs de verrouillage des jantes.  
Les arêtes vives de la douille NUTTWISTER® vont «mordre» l'écrou, le boulon ou le goujon et permettre ainsi facilement son extraction.



NUTTWISTER®



3129-32 (mm)		D <sub>1</sub> (mm)	D <sub>2</sub> (mm)	L (mm)	(g)	(pcs.)
2	3/8"	2	19	32	32	10
3		3	19	32	33	10
4		4	19	32	33	10
6		6	19	32	35	10
8		8	19	32	37	10
10		10	19	32	40	10

3129-60 (mm)		D <sub>1</sub> (mm)	D <sub>2</sub> (mm)	L (mm)	(g)	(pcs.)
2	3/8"	2	19	60	38	10
3		3	19	60	42	10
4		4	19	60	44	10
6		6	19	60	47	10
8		8	19	60	53	10
10		10	19	60	64	10

RS3129/6-L32	6 Pieces Set/Rail 150mm	(g)
2, 3, 4, 6, 8, 10		250

RS3129/6-L60	6 Pieces Set/Rail 150mm	(g)
2, 3, 4, 6, 8, 10		320

4129-37 (mm)		D <sub>1</sub> (mm)	D <sub>2</sub> (mm)	L (mm)	(g)	(pcs.)
8	1/2"	8	24	37	59	10
10		10	24	37	63	10
12		12	24	37	67	10
14		14	24	37	72	10
16		16	24	37	78	10

4129-75 (mm)		D <sub>1</sub> (mm)	D <sub>2</sub> (mm)	L (mm)	(g)	(pcs.)
8	1/2"	8	24	75	80	10
10		10	24	75	94	10
12		12	24	75	110	10
14		14	24	75	130	10
16		16	24	75	150	10

RS4129/5-L37	5 Pieces Set/Rail 150mm	(g)
8, 10, 12, 14, 16		370

RS4129/5-L75	5 Pieces Set/Rail 150mm	(g)
8, 10, 12, 14, 16		600



3129-32 / -60 BOLTTWISTER®

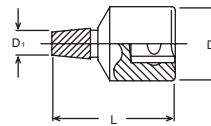

RS3129/6-L32 / -L60

Socket Set on Rail  
Steckschlüsselsatz auf Schiene  
Jeu de douilles sur rail

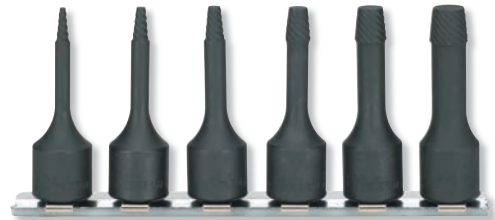

4129-37 / -75 BOLTTWISTER®

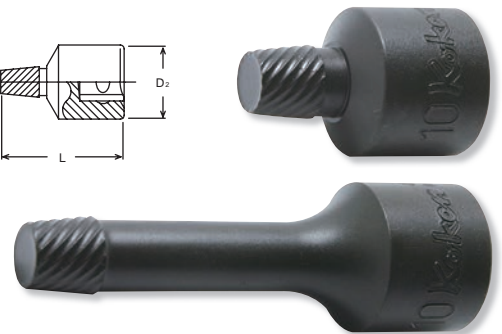
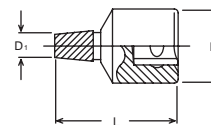

RS4129/5-L37 / -L75

Socket Set on Rail  
Steckschlüsselsatz auf Schiene  
Jeu de douilles sur rail

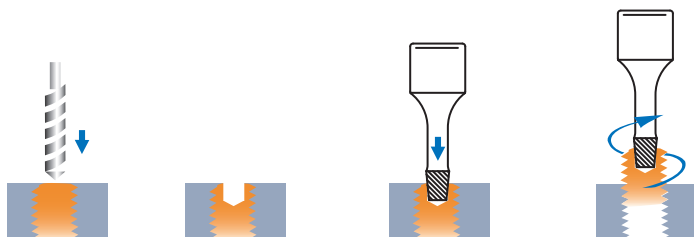

Effective method and easy solution for removing twisted off bolt. Drill a hole in the center of bolt and drive BOLTTWISTER® firmly into the hole. The sharp spiral edges will hold the broken bolt and easily remove it.

BOLTTWISTER	Bolt size	Drill size
2	M5	φ 2.4 ~ 2.6
3	M6	φ 3.2 ~ 3.5
4	M8	φ 4.2 ~ 4.5
6	M10 ~ M12	φ 6.2 ~ 6.5
8	M14 ~ M16	φ 8.2 ~ 8.5
10	M18 ~ M20	φ 10.2 ~ 10.5
12	M22 ~ M24	φ 12.2 ~ 12.5
14	M27 ~ M30	φ 14.2 ~ 14.5
16	M33	φ 16.2 ~ 16.5

# Ratcheting Ring Spanners



## Knarren-Ringschlüssel

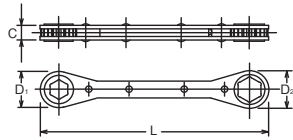

### Clés hexagonales à cliquet

Z-SERIES  
HAND  
TITANIUM  
ACCESSORIES  
SCREWDRIVERS  
IMPACT  
SLEEVE-DRIVE  
PROTECTOR  
INDUSTRIAL  
AUTOMOTIVE  
MOTORCYCLE  
CONSTRUCTION  
SPARE PART

## 102NM / 102NA Without reverse lever Nicht umstellbar Non réversible





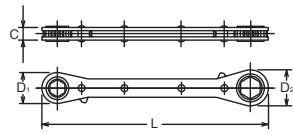

102NM (mm)	L (mm)	D <sub>1</sub> (mm)	D <sub>2</sub> (mm)	C (mm)	 (g)	 (pcs.)
6x7	108	15.3	16.4	7.5	60	10
7x8	108	15.3	16.4	7.5	60	10
8x9	134	17.1	19.7	7.5	80	10
8x10	134	17.1	19.7	7.5	80	10
10x11	140	20.1	22.7	7.5	87	10
10x12	140	20.1	22.7	7.5	87	10
11x13	145	23.6	24.6	9	112	10
12x13	145	23.6	24.6	9	112	10
12x14	145	23.6	24.6	9	112	10

102NA (inch)	L (mm)	D <sub>1</sub> (mm)	D <sub>2</sub> (mm)	C (mm)	 (g)	 (pcs.)
7/32 x 1/4	108	15.3	16.4	7.5	60	10
1/4 x 9/32	108	15.3	16.4	7.5	60	10
1/4 x 5/16	108	15.3	16.4	7.5	60	10
5/16 x 11/32	134	17.1	19.7	7.5	80	10
5/16 x 3/8	134	17.1	19.7	7.5	80	10
3/8 x 7/16	140	20.1	22.7	7.5	87	10
7/16 x 1/2	145	23.6	24.6	9	112	10
1/2 x 9/16	145	23.6	24.6	9	112	5

## 102KM / 102KA Reversible Umstellbar Réversible





102KM (mm)	L (mm)	D <sub>1</sub> (mm)	D <sub>2</sub> (mm)	C (mm)	 (g)	 (pcs.)
6x7	108	15.3	16.4	7.2	51	10
7x8	108	15.3	16.4	7.2	51	10
8x9	134	17	20	9.1	76	10
8x10	134	17	20	9.1	76	10
10x11	141	21	23.5	9.1	84	10
10x12	141	21	23.5	9.1	84	10
12x13	146	24	25	9.1	89	10
12x14	146	24	25	9.1	89	5
13x17	200	27.1	31.8	11.5	190	5
14x17	200	27.1	31.8	11.5	200	5

102KA (inch)	L (mm)	D <sub>1</sub> (mm)	D <sub>2</sub> (mm)	C (mm)	 (g)	 (pcs.)
7/32 x 1/4	108	15.3	16.4	7.2	51	10
1/4 x 5/16	108	15.3	16.4	7.2	51	10
5/16 x 11/32	134	17	20	9	76	10
3/8 x 7/16	141	21	23.5	9.1	84	10
1/2 x 9/16	146	24	25	9.1	89	5

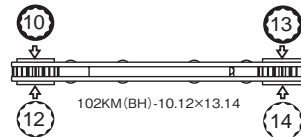

## 102KM.BH With Twin Openings (Two-in-One) Doppel-Ringschlüssel (zwei Öffnungen in einer) Ouvertures doubles



102KM.BH (mm)	L (mm)	D <sub>1</sub> (mm)	D <sub>2</sub> (mm)	C (mm)	 (g)	 (pcs.)
5.5- 6x 7- 8	108	15.3	16.4	10	60	10
8 -10x12-13	141	21	23.5	13	87	10
9 -10x11-12	141	21	23.5	13	87	10
10 -12x13-14	146	24	25	13	98	10
13 -14x15-17	200	27.1	31.8	16	200	5

## 102KT Reversible TORX® Umstellbar TORX® Réversible TORX®



102KT (E)	L (mm)	D <sub>1</sub> (mm)	D <sub>2</sub> (mm)	C (mm)	 (g)	 (pcs.)
E 4xE 6	108	15.3	16.4	7.5	51	10
E 6xE 8	108	15.3	16.4	7.5	51	10
E10xE12	134	17	20	9	76	10

103KM (mm)	L (mm)	D <sub>1</sub> (mm)	D <sub>2</sub> (mm)	C (mm)	(g)	(pcs.)
6x 7	108	15.3	16.4	7.5	51	5
7x 8	108	15.3	16.4	7.5	51	5
8x 9	134	17	20	9	76	5
8x10	134	17	20	9	76	5
10x11	140	21	23.5	9	84	5
10x12	140	21	23.5	9	84	5
12x13	145	24	25	9	89	5
12x14	145	24	25	9	89	5

103KA (inch)	L (mm)	D <sub>1</sub> (mm)	D <sub>2</sub> (mm)	C (mm)	(g)	(pcs.)
7/32x 1/4	108	15.3	16.4	7.5	51	5
1/4 x 5/16	108	15.3	16.4	7.5	51	5
5/16x11/32	134	17	20	9	76	5
5/16x 3/8	134	17	20	9	76	5
3/8 x 7/16	140	21	23.5	9	84	5
7/16x 1/2	145	24	25	9	89	5
1/2 x 9/16	145	24	25	9	89	5

103KA.BH (inch)	L (mm)	D <sub>1</sub> (mm)	D <sub>2</sub> (mm)	C (mm)	(g)	(pcs.)
1/4x5/16	108	15.3	16.4	7.5	51	5
3/8x7/16	140	21	23.5	9	84	5
1/2x9/16	145	24	25	9	89	5

103KT (E)	L (mm)	D <sub>1</sub> (mm)	D <sub>2</sub> (mm)	C (mm)	(g)	(pcs.)
E 4xE 6	104	15.3	16.4	7.5	51	5
E 6xE 8	104	15.3	16.4	7.5	51	5
E10xE12	128	17	20	9	76	5
E14xE16	139	24	25	9	89	5

145KM (mm)	L (mm)	D (mm)	C (mm)	(g)	(pcs.)
10H	125	20.1	7.5	72	10



150-10H (mm)	D (mm)	H (mm)	L (mm)	(g)	(pcs.)
5	12	3.5	11	6	10
6	12	4.5	12.5	7	10
7	12	5	14	7	10
8	12	6	15.5	7	10
9	13	6	16	7	10
10	14.3	7	17	9	10
12	17.4	9	19.5	14	10

1203		7 Pieces Set/△=250g	
METAL CASE:W130xH65xT20mm			
Sockets		Accessory	
150.10H 5, 6, 7, 8, 9, 10	145KM-10H		

**103KM / 103KA** Reversible  
Umstellbar  
Réversible

**103KA.BH** Reversible (12P)  
Umstellbar (12P)  
Réversible (12P)

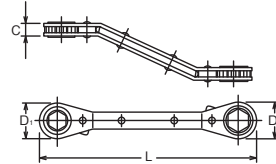

**103KT** Reversible TORX®  
Umstellbar TORX®  
Réversible TORX®

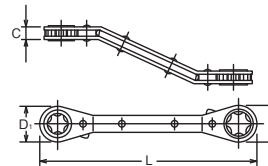
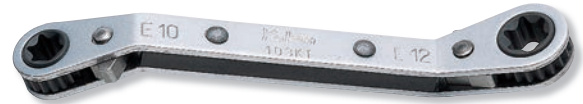

**145KM-10H** Reversible, 10mm 6-pt.  
Verstellbar SW10mm  
Réversible 10mm

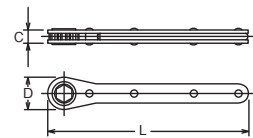

**150-10H** Sockets with 10mm 6-point Drive End  
Steckschlüssel mit 10mm Sechskant-Antrieb  
Douilles à conducteur de 10mm 6-pans mâle

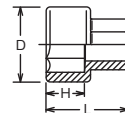

**1203** Sockets with 10mm 6-point Drive End in Set with Ratchet  
Steckschlüssel mit 10mm Sechskant-Antrieb mit Knarre im Satz  
Jeu de douilles à conducteur 10mm 6-pans mâle, avec cliquet



# Ratcheting Ring Spanners



## Knarren-Ringschlüssel

### Clés hexagonales à cliquet

Z-SERIES  
HAND  
TITANIUM  
ACCESSORIES  
SCREWDRIVERS  
IMPACT  
SLEEVE-DRIVE  
PROTECTOR  
INDUSTRIAL  
AUTOMOTIVE  
MOTORCYCLE  
CONSTRUCTION  
SPARE PART

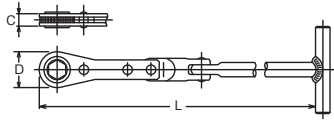

**154M**  Push and Pull-Ratchets  
Hub-Knarren  
Clé à cliquet de levage



154M (mm)	L (mm)	D (mm)	C (mm)	 (g)	 (pcs.)
8	294	17.1	7.5	178	2
10	297	20.1	7.5	183	2
12	300	23.6	9	189	2
13	301	24.6	9	194	2
14	301	24.6	9	194	2

**154ML**  Push and Pull-Ratchets  
Hub-Knarren  
Clé à cliquet de levage



154ML (mm)	L (mm)	D (mm)	C (mm)	 (g)	 (pcs.)
10	297	20.1	7.5	230	2
12	300	23.6	9	252	2

**1206**  Push and Pull-Ratchet  
Hub-Knarre  
Clé à cliquet de levage

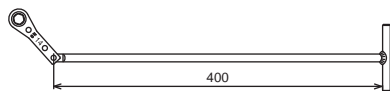

1206		3 Pieces Set/△=320g
CARDBOARD BOX		
Sockets		Accessory
 150.14H Sockets 12, 14	154K-14	

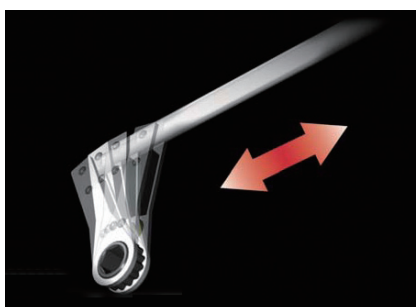



# Ratcheting Ring Spanners Knarren-Ringschlüssel Clés hexagonales à cliquet

137	L (mm)	D <sub>1</sub> (mm)	D <sub>2</sub> (mm)	C (mm)	(g)	(pcs.)
	141	23.5	21	9	104	5

1/4" × 3/8"

138	L (mm)	D <sub>1</sub> (mm)	D <sub>2</sub> (mm)	C (mm)	(g)	(pcs.)
	141	23.5	21	9	97	10

1/4" × 1/4"

139	L (mm)	D (mm)	C (mm)	(g)	(pcs.)
	125	20.1	7.5	80	10

1/4"

R810 (inch)	L (mm)	D <sub>1</sub> (mm)	D <sub>2</sub> (mm)	C (mm)	(g)	(pcs.)
1/4×5/16	108	15.3	16.4	7.5	60	10
3/8×7/16	140	20.1	22.7	7.5	87	10
1/2×9/16	145	23.6	24.6	9	112	10

**137**  For 1/4" and 3/8" Square Drive Sockets  
Für Steckschlüssel mit 1/4" und 3/8" Antrieb  
Pour douilles d'un carré conducteur de 1/4" et 3/8"

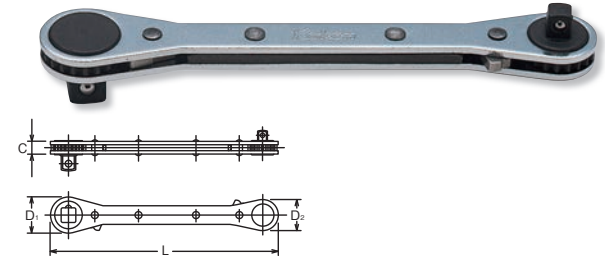

**138**  For Bits 101  
Für Klängen 101  
Pour embouts 101

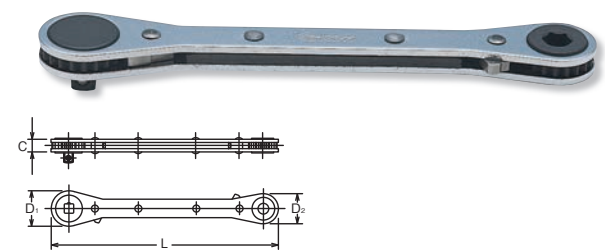

**139**  For 1/4" Square Drive Sockets  
Für Steckschlüssel mit 1/4" Antrieb  
Pour douilles d'un carré conducteur de 1/4"

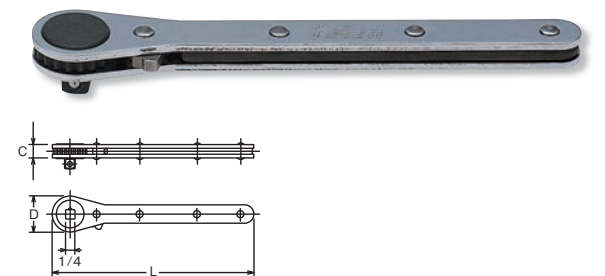

**R810**  Reversible (12P)  
Umstellbar (12P)  
Réversible (12P)

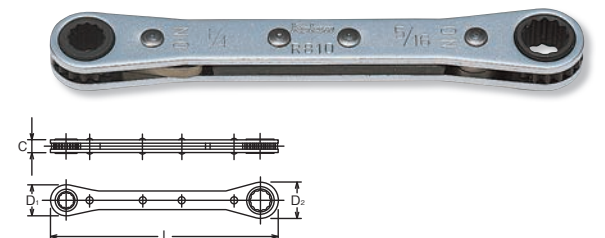

# Ratcheting Ring Spanners

## Knarren-Ringschlüssel

### Clés hexagonales à cliquet

Z-SERIES  
HAND  
TITANIUM  
ACCESSORIES  
SCREWDRIVERS  
IMPACT  
SLEEVE-DRIVE  
PROTECTOR  
INDUSTRIAL  
AUTOMOTIVE  
MOTORCYCLE  
CONSTRUCTION  
SPARE PART

#### 101P PH Bits PH Bits Embouts, PH

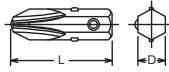

101P (PH)	D (mm)	L (mm)	(g)	(pcs.)
1	6.35	20.5	3	10
2	6.35	20.5	4	10
3	6.35	20.5	5	10

#### 101S Slotted Bits Schlitz Bits Embouts, fente

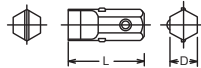

101S	D (mm)	L (mm)	(g)	(pcs.)
1.0x7	6.35	15	3	10
1.2x7	6.35	15	3	10

#### 101H Hex Bits Sechskant Bits Embouts, 6 pans creux

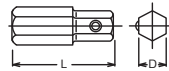

101H (mm)	D (mm)	L (mm)	(g)	(pcs.)
3	6.35	20.5	5	10
4	6.35	20.5	5	10
5	6.35	20.5	5	10
6	6.35	20.5	5	10
7	6.35	20.5	6	10
8	6.35	20.5	7	10

#### 101B Ball-point Hex Bits Sechskant Bits Embouts, 6 pans creux

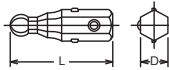

101B (mm)	D (mm)	L (mm)	(g)	(pcs.)
3	6.35	25	4	10
4	6.35	25	4	10
5	6.35	25	5	10
6	6.35	25	5	10

 Ball point bits have less strength due to the special design. Make sure to use them correctly.

#### 101T (T) TORX® Bits TORX® Bits Embouts, TORX®

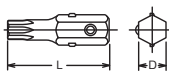

101T (T)	D (mm)	L (mm)	(g)	(pcs.)
T 9	6.35	25	4	10
T10	6.35	25	4	10
T15	6.35	25	5	10
T20	6.35	25	5	10
T25	6.35	25	5	10
T27	6.35	25	6	10
T30	6.35	25	6	10

#### 101T (TH) Tamper-Resistant TORX® Bits TORX® Bits Embouts, TORX®

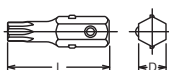

101T (TH)	D (mm)	L (mm)	(g)	(pcs.)
T10H	6.35	25	4	10
T15H	6.35	25	4	10
T20H	6.35	25	5	10
T25H	6.35	25	5	10
T27H	6.35	25	6	10
T30H	6.35	25	6	10

 Tamper Resistant TORX® Bits have less strength due to special design. Make sure to use it correctly.

128H (mm)	D (mm)	L (mm)	(g)	(pcs.)
3	8	32	11	10
4	8	32	11	10
5	8	32	12	10
6	8	32	12	10
8	8	32	13	10

128T (T)	D (mm)	L (mm)	(g)	(pcs.)
T10	8	32	9	10
T15	8	32	9	10
T20	8	32	9	10
T25	8	32	10	10
T27	8	32	10	10
T30	8	32	11	10

101A	D (mm)	S (mm)	L (mm)	(g)	(pcs.)
	8	6.35	20	8	10

**128H** Hex Bits  
Sechskant Bits  
Embouts, 6 pans creux



**128T** TORX® Bits  
TORX® Bits  
Embouts, TORX®



**101A** Adaptor  
Verbindungsstück  
Adaptateur



1202		15 Pieces Set/420g
METAL CASE:W190xH60xT30mm		
Bits	Accessory	
<p><b>101P</b> Phillips Bits 1, 2, 3</p> <p><b>101S</b> Slotted Bit 1x7</p> <p><b>101B</b> Ballpoint Hex Bits 3, 4, 5, 6</p> <p><b>101T</b> TORX® Bits T10, T15, T20, T25, T27, T30</p>	<b>138</b>	

**1202** Bit Set  
Bit-Satz  
Jeu d'embouts



2254M		12 Pieces Set/450g
METAL CASE:W160xH100xT28mm		
Bits	Accessories	
<p><b>101P</b> Phillips Bits 1, 2, 3</p> <p><b>101S</b> Slotted Bits 1x7, 1.2x7</p> <p><b>101H</b> Hex Bits 3, 4, 5</p>	<b>102NA-1/4x5/16</b> <b>2769F</b> <b>101A</b> <b>2137</b>	

**2254M** Bit Set  
Bit-Satz  
Jeu d'embouts



# Ratcheting Ring Spanners Knarren-Ringschlüssel Clés hexagonales à cliquet

Z-SERIES  
HAND  
TITANIUM  
ACCESSORIES  
SCREWDRIVERS  
IMPACT  
SLEEVE-DRIVE  
PROTECTOR  
INDUSTRIAL  
AUTOMOTIVE  
MOTORCYCLE  
CONSTRUCTION  
SPARE PART

**R810A** Bit Set  
Bit-Satz  
Jeu d'embouts



<b>R810A</b> 5 Pieces Set/△=208g	
METAL CASE:W130xH65xT20mm	
Bits	Accessory
<b>101P</b> Phillips Bits 1, 2, 3 <b>101S</b> Slotted Bit 1x7	<b>102NA-1/4x5/16</b>

**R810B** Bit Set  
Bit-Satz  
Jeu d'embouts



<b>R810B</b> 10 Pieces Set/△=268g	
METAL CASE:W130xH65xT20mm	
Bits	Accessory
<b>101P</b> Phillips Bits 1, 2, 3 <b>101S</b> Slotted Bit 1x7 <b>128H</b> Hex Bits 3, 4, 5, 6, 8	<b>102NA-1/4x5/16</b>

**R810C** Bit and Socket Set  
Bit und Steckschlüssel Satz  
Jeu de douilles et d'embouts



<b>R810C</b> 12 Pieces Set/△=227g	
METAL CASE:W130xH65xT20mm	
Bits, Sockets	Accessories
<b>101P</b> Phillips Bits 1, 2, 3 <b>101S</b> Slotted Bit 1x7 <b>2400M</b> Sockets 5, 6, 7, 8, 9, 10	<b>102NA-1/4x5/16</b> <b>101A</b>

**R810D** Bit and Socket Set  
Bit und Steckschlüssel Satz  
Jeu de douilles et d'embouts



<b>R810D</b> 17 Pieces Set/△=336g	
METAL CASE:W130xH65xT20mm	
Bits, Sockets	Accessories
<b>101P</b> Phillips Bits 1, 2, 3 <b>101S</b> Slotted Bit 1x7 <b>128H</b> Hex Bits 3, 4, 5, 6, 8 <b>2400M</b> Sockets 5, 6, 7, 8, 9, 10	<b>102NA-1/4x5/16</b> <b>101A</b>

**R810E** Socket Set  
Steckschlüssel Satz  
Jeu de clés à douilles



<b>R810E</b> 9 Pieces Set/△=445g	
METAL CASE:W130xH65xT20mm	
Sockets	Accessories
<b>2300M</b> Deep Sockets 6, 7, 8, 9, 10, 11, 12	<b>102NA-1/4x5/16</b> <b>101A</b>





**156M**  6-Point Deep  
6-kant, lang  
Longues 6-pans

156M (mm)	D (mm)	H <sub>1</sub> (mm)	H <sub>2</sub> (mm)	L <sub>1</sub> (mm)	L <sub>2</sub> (mm)	(g)	(pce.)
8	12	9	41	355	200	231	1
10	14.5	11	41	355	200	289	1
12	16.8	13	41	355	200	429	1
14	20	16	41	355	200	454	1

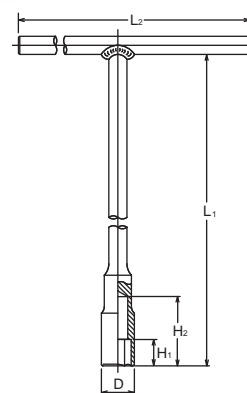

**104ME / 104A**  6-Point  
6-kant  
6-pans

104ME (mm)	D (mm)	H (mm)	L <sub>1</sub> (mm)	L <sub>2</sub> (mm)	(g)	(pce.)
6	9.5	8	200	180	150	1
7	11	9	200	180	152	1
8	12	10	250	200	183	1
9	14	12	250	200	188	1
10	14	13	250	200	230	1
11	16	14	250	200	234	1
12	18	15	250	200	355	1
13	18.5	17	250	250	390	1
14	20	18	250	250	399	1
15	21	19	250	250	404	1
16	22.5	21	250	250	419	1
17	24	22	250	250	568	1
18	25	23	250	250	577	1
19	26.5	25	250	250	594	1

104A (inch)	D (mm)	H (mm)	L <sub>1</sub> (mm)	L <sub>2</sub> (mm)	(g)	(pce.)
1/4	9.5	8	200	180	150	1
5/16	12	10	250	200	183	1
3/8	14	12	250	200	188	1
7/16	16	14	250	200	234	1
1/2	18.5	17	300	250	412	1
9/16	20	18	300	250	428	1
5/8	22.5	21	350	300	528	1
3/4	26.5	25	350	300	717	1

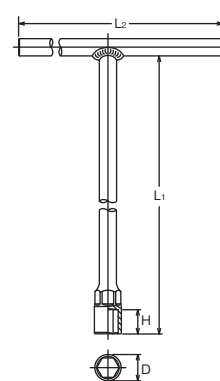
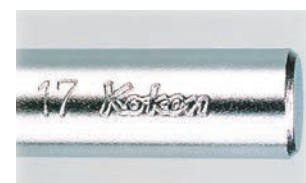

Z-SERIES  
HAND  
TITANIUM  
ACCESSORIES  
SCREWDRIVERS  
IMPACT  
SLEEVE-DRIVE  
PROTECTOR  
INDUSTRIAL  
AUTOMOTIVE  
MOTORCYCLE  
CONSTRUCTION  
SPARE PART

**3116M**  Universal with 6-point Socket  
Gelenk mit 6-kant Steckschlüssel  
Cardan avec douille 6-pans



**124M-600 (2B)**

 Ball Joint plus Nut Grip Socket  
Kugelgelenk mit 2-facher Kugelhalterung  
Douilles articulées avec deux billes de retenue

3116M (mm)	D (mm)	H (mm)	L <sub>1</sub> (mm)	L <sub>2</sub> (mm)	(g)	(pce.)
10	14.5	8	800	190	796	1
12	17	10.3	800	190	797	1
13	18	11.3	800	190	797	1
14	19.5	11.3	800	190	797	1
15	21	12.8	800	190	799	1
16	22	12.8	800	190	806	1
17	23.6	13.8	800	190	801	1
18	24	13.8	800	190	809	1

124M-600 (mm)	D (mm)	H (mm)	L <sub>1</sub> (mm)	L <sub>2</sub> (mm)	(g)	(pce.)
8(2B)	12	5	600	200	332	1
10(2B)	14.5	6	600	200	334	1
12(2B)	16.8	7	600	200	424	1
13(2B)	18	8	600	200	425	1
14(2B)	19.5	8.5	600	200	527	1
17(2B)	23.3	9.5	600	200	538	1

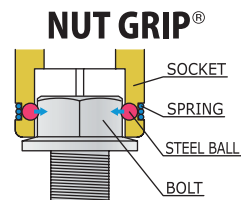

**NUT GRIP®**

Twin balls at the 6-point opening hold bolt/nut tightly for safe and reliable work.

Die zwei Kugeln in der 6-kant Öffnung unserer NUT GRIP Steckschlüssel halten die Schraube sicher im Steckschlüssel. Dies erlaubt ein Arbeiten auch an schwer zugänglichen Stellen.

Les 2 billes dans l'ouverture du 6-pans de la douille retiennent l'écrou de manière sûre et efficace.

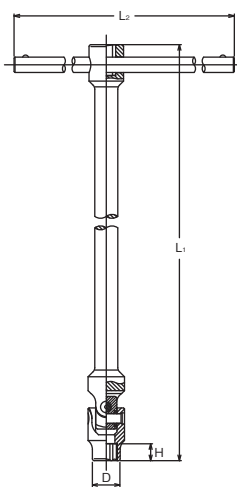



photo: 3116M

**157HE**  For Inhex Screws  
Für Innensechskant-Schrauben  
Pour vis à 6-pans creux

157HE (mm)	L <sub>1</sub> (mm)	L <sub>2</sub> (mm)	(g)	(pce.)
3	250	180	98	1
4	250	180	121	1
5	250	180	158	1
6	250	180	416	1
8	250	180	422	1
10	300	190	440	1
12	320	210	660	1

**157T**  For TORX® Screws  
Für TORX®-Schrauben  
Pour vis TORX®

157T (T)	L <sub>1</sub> (mm)	L <sub>2</sub> (mm)	(g)	(pce.)
T25	250	180	95	1
T27	250	180	96	1
T30	250	180	167	1
T40	250	180	168	1
T45	250	180	213	1
T50	250	180	215	1

**157S**  For Slotted Heads  
Für Schlitzschrauben  
Pour vis à fente

157S	TxW	L <sub>1</sub> (mm)	L <sub>2</sub> (mm)	(g)	(pce.)
6	1.0x6	200	180	84	1
8	1.2x8	250	180	170	1

**157PE**  For Phillips Screws  
Für Kreuzschlitzschrauben, Phillips  
Pour vis à empreinte Phillips

157PE (PH)	L <sub>1</sub> (mm)	L <sub>2</sub> (mm)	(g)	(pce.)
2	250	180	95	1
3	250	180	170	1

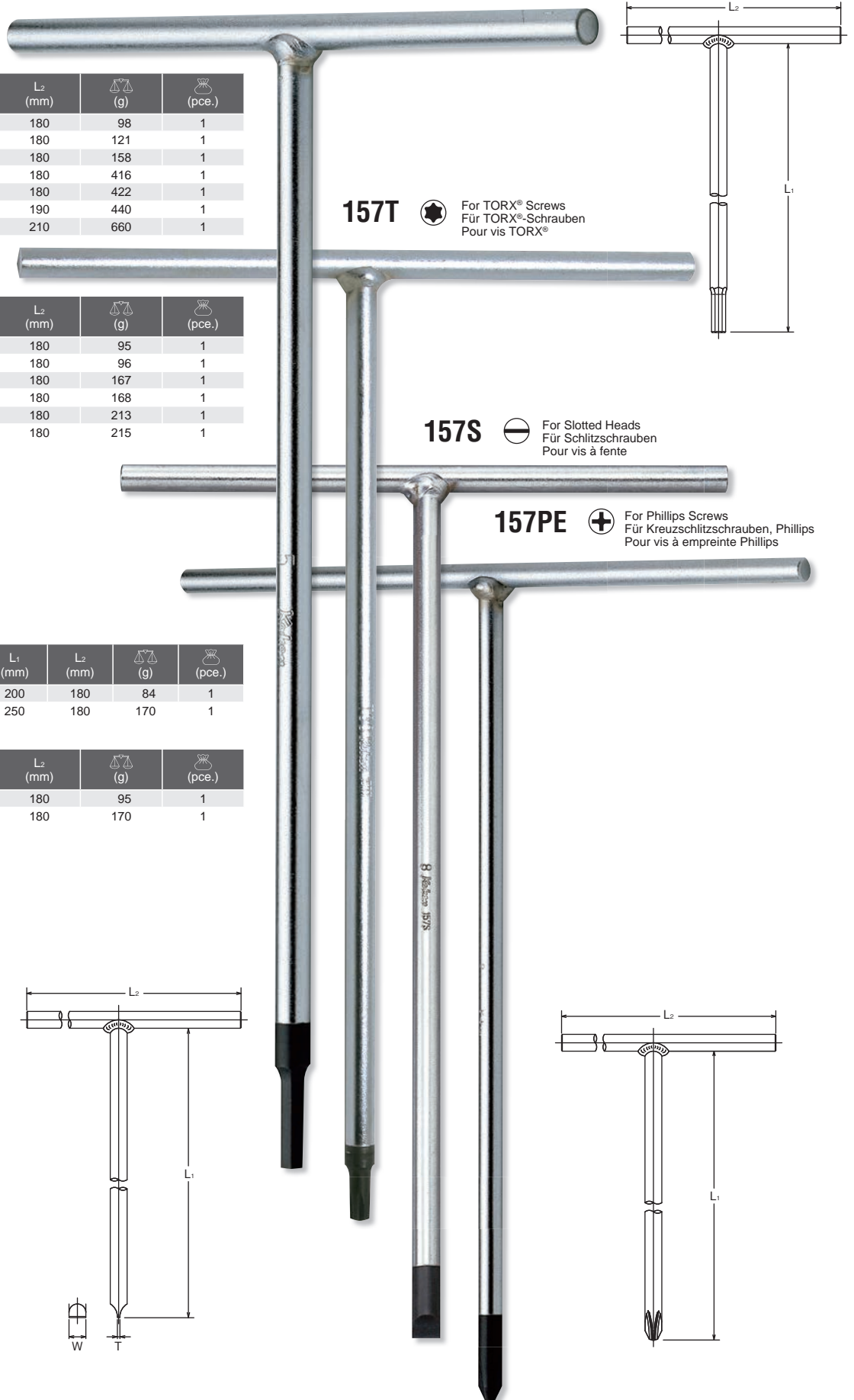

T-Handles  
T-Griffe  
Poignées en T

Z-SERIES  
HAND  
TITANIUM  
ACCESSORIES  
SCREWDRIVERS  
IMPACT  
SLEEVE-DRIVE  
PROTECTOR  
INDUSTRIAL  
AUTOMOTIVE  
MOTORCYCLE  
CONSTRUCTION  
SPARE PART

**2715**  T-Handle  
T-Griff  
Poignée coulissante



**3715**  T-Handle  
T-Griff  
Poignée coulissante



**3715S**  T-Handle  
T-Griff  
Poignée coulissante



**3715SL**  T-Handle  
T-Griff  
Poignée coulissante





**3715SLK**  T-Handle  
T-Griff  
Poignée coulissante

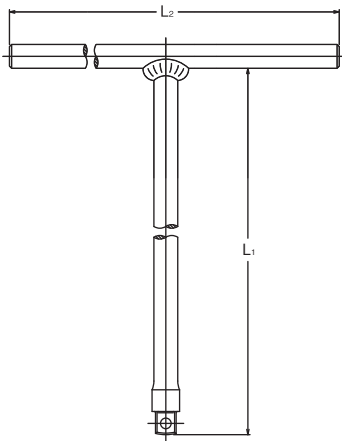

**3716**  T-Handle  
T-Griff  
Poignée coulissante

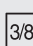

		L <sub>1</sub> (mm)	L <sub>2</sub> (mm)	 (g)	 (pce.)
<b>2715</b>		200	120	130	1

		L <sub>1</sub> (mm)	L <sub>2</sub> (mm)	 (g)	 (pce.)
<b>3715</b>		268	240	386	1
<b>3715S</b>		268	190	347	1
<b>3715SL</b>		237	200	325	1
<b>3715SLK</b>		236	200	470	1
<b>3716</b>		268	240	379	1

3716  
3716 has a reduced square drive and similar function as offset extension bars.



photo: 3715SLK





**4715**  T-Handle  
T-Griff  
Poignée coulissante







**4715S**  T-Handle  
T-Griff  
Poignée coulissante

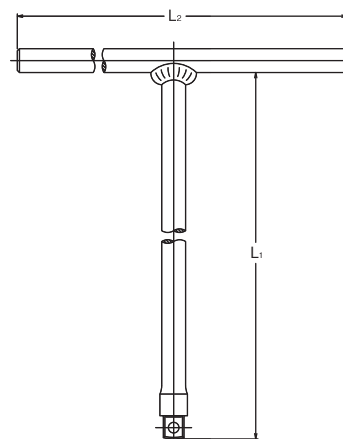

**4715SL**  T-Handle  
T-Griff  
Poignée coulissante



		L <sub>1</sub> (mm)	L <sub>2</sub> (mm)	 (g)	 (pce.)
4715		267	255	475	1
4715S		267	170	402	1
4715SL		250	250	640	1

**4711X**  Spinning cross wrench  
T-Griff für die Radmuttermontage  
Poignée coulissante pour montage des écrous à roue

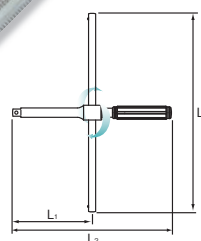
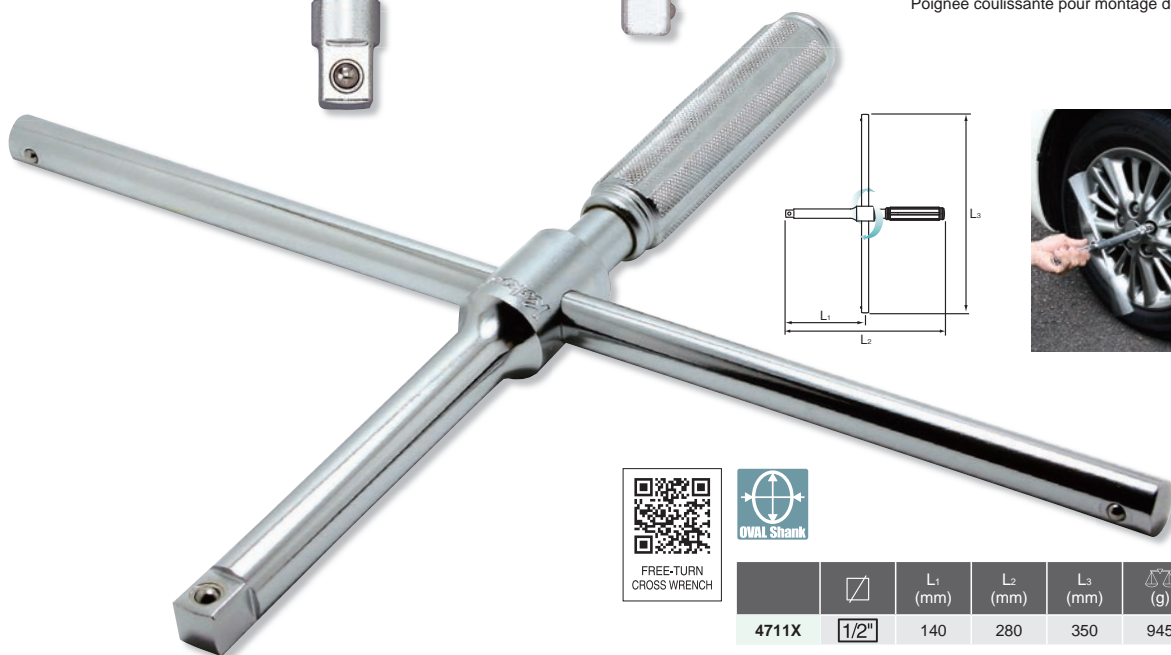

		L <sub>1</sub> (mm)	L <sub>2</sub> (mm)	L <sub>3</sub> (mm)	 (g)	 (pce.)
4711X		140	280	350	945	1

# Attack Drivers

## Hand-Schlagschrauber

### Tournevis à frapper

Z-SERIES  
HAND  
TITANIUM  
ACCESSORIES  
SCREWDRIVERS  
IMPACT  
SLEEVE-DRIVE  
PROTECTOR  
INDUSTRIAL  
AUTOMOTIVE  
MOTORCYCLE  
CONSTRUCTION  
SPARE PART

**3112G** Attack Driver  
Handschlagschrauber  
Tournevis à frapper



	□	L (mm)	⚖ (g)	📦 (pce.)
<b>3112G</b>	3/8"	159	810	1

\* Renewal Kits → **3112RK** → P306

**4112G** Attack Driver  
Handschlagschrauber  
Tournevis à frapper



	□	L (mm)	⚖ (g)	📦 (pce.)
<b>4112G</b>	1/2"	163	810	1
<b>4112N</b>	1/2"	163	730	1

\* Renewal Kits → **4112RK** → P306

**4112N** Attack Driver  
Handschlagschrauber  
Tournevis à frapper



	□	L (mm)	⚖ (g)	📦 (pce.)
<b>6112</b>	3/4"	190	1900	1

\* Renewal Kits → **6112RK** → P306



Black finished striking head prevents the problem of peeling.  
Das geschwärzte Schlagende vermeidet das Abspringen von Chromteilen.  
La finition "black finish" de la tête évite l'écaillage du au chromage.

**6112** Attack Driver  
Handschlagschrauber  
Tournevis à frapper





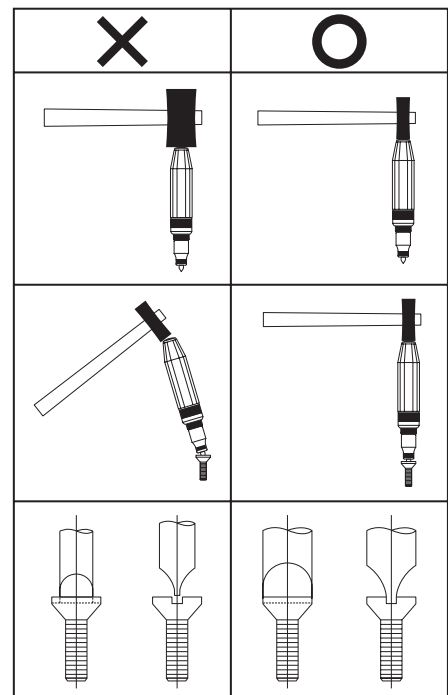

ATTACK DRIVER®



**AG318A** 6 Pieces Set/△=1,150g

METAL CASE:W220xH82xT60mm

Bits	Accessories
 <b>100P.32</b> Phillips Bits 2, 3	 <b>3112G</b>
 <b>100S.32</b> Slotted Bits 9, 11	 <b>3138</b>

**AG112A** 6 Pieces Set/△=1,150g







METAL CASE:W220xH82xT60mm

Bits	Accessories
 <b>100P.32</b> Phillips Bits 2, 3	 <b>4112G</b>
 <b>100S.32</b> Slotted Bits 9, 11	 <b>4138</b>

100P, S Bits → P158

**AG112H** 18 Pieces Set/△=1,480g









METAL CASE:W220xH82xT60mm

Bits	Accessories
 <b>100P.32</b> Phillips Bits 2, 3, 4	 <b>4112G</b>
 <b>100S.32</b> Slotted Bits 8, 9, 10, 12, 14	 <b>4138</b>
 <b>100H.32</b> Hex Bits 5, 6, 8, 10	
 <b>100T.32</b> TORX® Bits T30, T40, T45, T50	

100P, S, H, T Bits → P158

**AG112F** 25 Pieces Set/△=1,530g





METAL CASE:W220xH82xT60mm

Bits	Accessories
 <b>100P.32</b> Phillips Bits 2, 3	 <b>4112G</b>
 <b>100P.32</b> PZ Bits PZ2, PZ3	 <b>4138</b>
 <b>100S.32</b> Slotted Bits 9, 11	
 <b>100H.32</b> Hex Bits 4, 5, 6, 7, 8, 10	
 <b>100T.32</b> TORX® Bits T25, T27, T30, T40, T45, T50	
 <b>100X.32</b> XZN Bits M5, M6, M8, M10, M12	

100P, S, H, T, X Bits → P158-159

**AN112A** 6 Pieces Set/△=1,070g





METAL CASE:W190xH59xT45mm

Bits	Accessories
 <b>100P.32</b> Phillips Bits 2, 3	 <b>4112N</b>
 <b>100S.32</b> Slotted Bits 9, 11	 <b>4138</b>

100P, S Bits → P158

**AN112C** 8 Pieces Set/△=1,350g

METAL CASE:W220xH82xT60mm

Bits	Accessories
 <b>100P.80</b> Phillips Bits 1, 2, 3	 <b>4112N</b>
 <b>100S.80</b> Slotted Bits 7, 9, 12	 <b>4138</b>

100P, S Bits → P158

**AG318A** Attack Driver Set  
Handschlagschrauber-Satz  
Jeu de tournevis à frapper



**AG112H** Attack Driver Set  
Handschlagschrauber-Satz  
Jeu de tournevis à frapper



**AG112F** Attack Driver Set  
Handschlagschrauber-Satz  
Jeu de tournevis à frapper



**AN112A** Attack Driver Set  
Handschlagschrauber-Satz  
Jeu de tournevis à frapper



**AN112C** Attack Driver Set  
Handschlagschrauber-Satz  
Jeu de tournevis à frapper

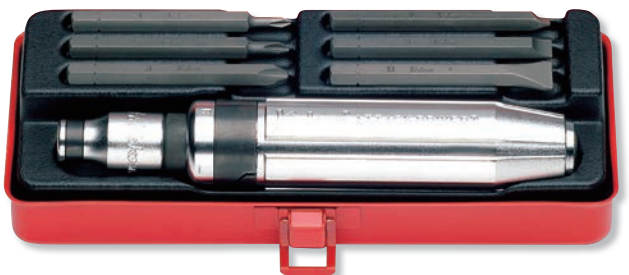

Z-SERIES  
HAND  
TITANIUM  
ACCESSORIES  
SCREWDRIVERS  
IMPACT  
SLEEVE-DRIVE  
PROTECTOR  
INDUSTRIAL  
AUTOMOTIVE  
MOTORCYCLE  
CONSTRUCTION  
SPARE PART

**108P-25 / -32 / -50**  PH Bits  
PH Bits  
Embouts, PH

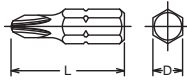

**108S-25 / -39**  Slotted Bits  
Schlitz Bits  
Embouts, fente

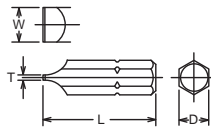

**108H-25**  Hex Bits  
Sechskant Bits  
Embouts, 6 pans creux

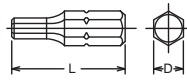

**108T-25 (T)**  TORX® Bits  
TORX® Bits  
Embouts, TORX®

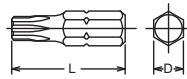

**108T-25 (TH)**  Tamper-Resistant TORX® Bits  
Tamper-Resistant TORX® Bits  
Embouts TORX®, Tamper-Resistant 

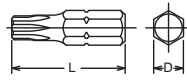

 Tamper Resistant TORX® Bits have less strength due to special design.  
Make sure to use it correctly.

**108A**  Adaptor  
Verbindungsstück  
Adaptateur

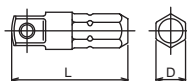

108P-25 (PH)	D (mm)	L (mm)	(g)	(pcs.)
1	6.35	25	5	10
2	6.35	25	5	10
3	6.35	25	6	10

108P-32 (PH)	D (mm)	L (mm)	(g)	(pcs.)
1	6.35	32	7	10
2	6.35	32	7	10
3	6.35	32	8	10

108P-50 (PH)	D (mm)	L (mm)	(g)	(pcs.)
1	6.35	50	10	10
2	6.35	50	11	10
3	6.35	50	11	10

108S-25	TxW (mm)	D (mm)	L (mm)	(g)	(pcs.)
3	0.5x3	6.35	25	3	10
4	0.6x4	6.35	25	3	10
4.5	0.6x4.5	6.35	25	4	10
5	0.8x5	6.35	25	5	10
5.5	0.8x5.5	6.35	25	5	10
6	1.0x6	6.35	25	5	10
8	1.2x8	6.35	25	6	10

108S-39	TxW (mm)	D (mm)	L (mm)	(g)	(pcs.)
3	0.5x3	6.35	39	6	10
4	0.6x4	6.35	39	6	10
4.5	0.6x4.5	6.35	39	6	10
5	0.8x5	6.35	39	7	10
5.5	0.8x5.5	6.35	39	8	10
6	1.0x6	6.35	39	9	10
8	1.2x8	6.35	39	12	10

108H-25 (mm)	D (mm)	L (mm)	(g)	(pcs.)
3	6.35	25	4	10
4	6.35	25	5	10
5	6.35	25	5	10
6	6.35	25	6	10
7	6.35	25	7	10
8	6.35	25	8	10
10	6.35	25	11	10

108H-25 (inch)	D (mm)	L (mm)	(g)	(pcs.)
1/8	6.35	25	4	10
9/64	6.35	25	5	10
5/32	6.35	25	5	10
3/16	6.35	25	5	10
7/32	6.35	25	6	10
1/4	6.35	25	7	10

108T-25 (T)	D (mm)	L (mm)	(g)	(pcs.)
T 8	6.35	25	4	10
T10	6.35	25	4	10
T15	6.35	25	4	10
T20	6.35	25	5	10
T25	6.35	25	6	10
T27	6.35	25	6	10
T30	6.35	25	6	10
T40	6.35	25	6	10

108T-25 (TH)	D (mm)	L (mm)	(g)	(pcs.)
T10H	6.35	25	4	10
T15H	6.35	25	4	10
T20H	6.35	25	5	10
T25H	6.35	25	6	10
T27H	6.35	25	6	10
T30H	6.35	25	6	10
T40H	6.35	25	6	10

108A-25	D (mm)	L (mm)	(g)	(pcs.)
1/4B	6.35	25	10	10



		D <sub>1</sub> (mm)	D <sub>2</sub> (mm)	L (mm)	(g)	(pcs.)
2137	1/4"	12	12	22.5	13	10
3137	3/8"	13	16.5	30	30	10
4137	1/2"	13	22	38	53	10

For DIN3126 C6.3 Bits  
Für DIN3126 C6.3 Bits  
Pour DIN3126 C6.3 Embouts

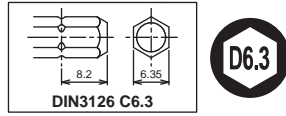

- 2137 Bit Holder  
Klingenhalter  
Porte-embouts
- 3137
- 4137

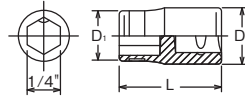

		D <sub>1</sub> (mm)	D <sub>2</sub> (mm)	L (mm)	(g)	(pcs.)	
12139	1/4"	11	13	25	15	10	*1
13139	3/8"	11	19	30	32	10	*2
14139	1/2"	11	25	35	62	10	*3

\*1 Pin/O-Ring=1200A/B  
\*2 C-Ring=1301C,Pin/O-Ring=1301A/B  
\*3 C-Ring=1401C,Pin/O-Ring=1401A/B

→ P254-255

For DIN3126 C6.3 Bits  
Für DIN3126 C6.3 Bits  
Pour DIN3126 C6.3 Embouts

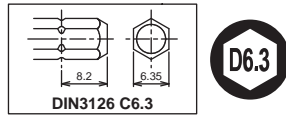

- 12139 Impact Bit Holder  
Impact Klingenhalter  
Porte embouts Impact
- 13139
- 14139

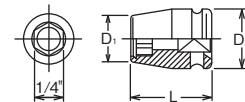

		D <sub>1</sub> (mm)	D <sub>2</sub> (mm)	L (mm)	(g)	(pcs.)	
13142-D6.3	3/8"	16	19	45	60	10	*1
14142-D6.3	1/2"	16	25	55	97	10	*2

\*1 C-Ring=1301C,Pin/O-Ring=1301A/B  
\*2 C-Ring=1401C,Pin/O-Ring=1401A/B

→ P254-255

For DIN3126 C6.3 Bits  
Für DIN3126 C6.3 Bits  
Pour DIN3126 C6.3 Embouts

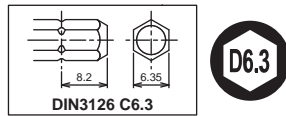

- 13142-D6.3 Impact Bit Holder Impact Klingenhalter Porte embouts Impact
- 14142-D6.3

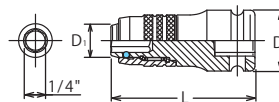

### Lock & Quick Release

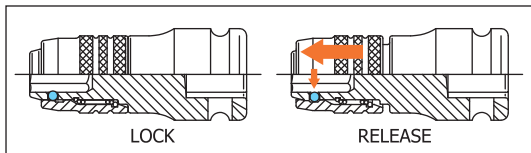

You may not hold the sliding part while moving to avoid heating up by friction and reduction by wear.

	D (mm)	H (mm)	L (mm)	(g)	(pcs.)
2749P-1/4HF	25	12	125	96	10
2774P-1/4HF	25	12	165	133	2

For DIN3126 C6.3 Bits  
Für DIN3126 C6.3 Bits  
Pour DIN3126 C6.3 Embouts

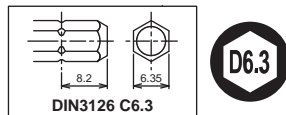

- 2749P-1/4HF Reversible Ratchet, for Bits 1/4"  
Knarre, verstellbar, für Bits 1/4"  
Cliquet, réversible pour embouts 1/4"



- 2774P-1/4HF Flexible Ratchet, reversible, for Bits 1/4"  
Gelenk-Knarre, verstellbar, für Bits 1/4"  
Cliquet à tête articulée pour embouts 1/4"

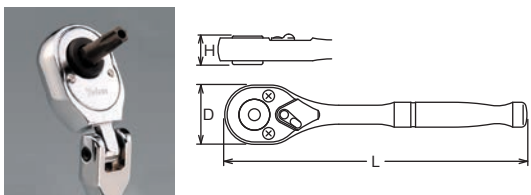

	D (mm)	H (mm)	L (mm)	(g)	(pcs.)
180M-50	11	13.5	50	15	10

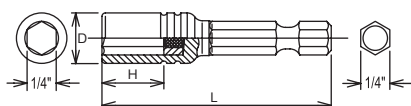

- 180M-50 Bit Holder with Magnet  
Klingenhalter mit Magnet  
Porte-embouts avec aimant





Z-SERIES  
HAND  
TITANIUM  
ACCESSORIES  
SCREWDRIVERS  
IMPACT  
SLEEVE-DRIVE  
PROTECTOR  
INDUSTRIAL  
AUTOMOTIVE  
MOTORCYCLE  
CONSTRUCTION  
SPARE PART

## 100P-32 / -80 / -125 PH Bits PH Bits Embouts, PH

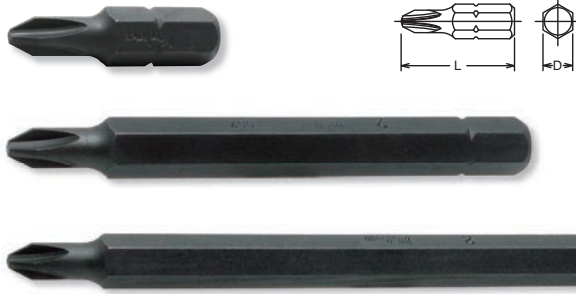

100P-32 (PH)	D (mm)	L (mm)	(g)	(pcs.)
1	8	32	11	10
2	8	32	11	10
3	8	32	12	10
4	8	32	12	10

100P-80 (PH)	D (mm)	L (mm)	(g)	(pcs.)
1	8	80	30	10
2	8	80	30	10
3	8	80	31	10
4	8	80	32	10

100P-125 (PH)	D (mm)	L (mm)	(g)	(pcs.)
2	8	125	48	10
3	8	125	49	10

## 100P-32 (PZ) PZ Bits PZ Bits Embouts, PZ



100P-32 (PZ)	D (mm)	L (mm)	(g)	(pcs.)
PZ2	8	32	10	10
PZ3	8	32	11	10

## 100S-32 / -80 Slotted Bits Schlitz Bits Embouts, fente

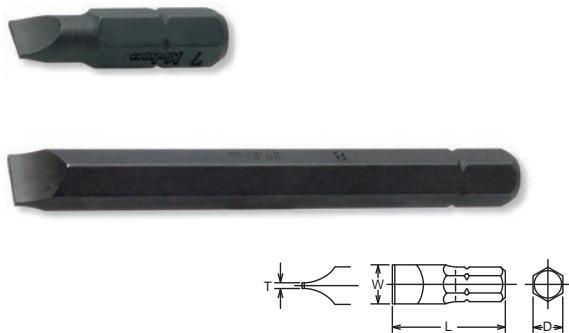

100S-32	TxW (mm)	D (mm)	L (mm)	(g)	(pcs.)
6	1 x 6	8	32	10	10
7	1 x 7	8	32	11	10
8	1.2x 8	8	32	12	10
9	1.6x 9	8	32	12	10
10	1.6x10	8	32	13	10
11	1.6x11	8	32	15	10
12	2 x12	8	32	18	10
14	2 x14	8	32	21	10

100S-80	TxW (mm)	D (mm)	L (mm)	(g)	(pcs.)
6	1 x 6	8	80	29	10
7	1 x 7	8	80	30	10
8	1.2x 8	8	80	31	10
9	1.6x 9	8	80	32	10
10	1.6x10	8	80	33	10
11	1.6x11	8	80	33	10
12	2 x12	8	80	34	10
14	2 x14	8	80	37	10

## 100H-32 Hex Bits Sechskant Bits Embouts, 6 pans creux



100H-32 (mm)	D (mm)	L (mm)	(g)	(pcs.)
3	8	32	11	10
4	8	32	11	10
5	8	32	12	10
6	8	32	12	10
7	8	32	13	10
8	8	32	13	10
9	8	32	16	10
10	8	32	16	10
11	8	32	20	10
12	8	32	23	10
14	8	32	29	10

## 100T-32 (T) TORX® Bits TORX® Bits Embouts, TORX®



100T-32 (T)	D (mm)	L (mm)	(g)	(pcs.)
T10	8	32	9	10
T15	8	32	9	10
T20	8	32	9	10
T25	8	32	10	10
T27	8	32	10	10
T30	8	32	11	10
T40	8	32	12	10
T45	8	32	12	10
T50	8	32	12	10
T55	8	32	12	10

100T-32 (TH)	D (mm)	L (mm)	(g)	(pcs.)
T10H	8	32	9	10
T15H	8	32	9	10
T20H	8	32	9	10
T25H	8	32	10	10
T27H	8	32	10	10
T30H	8	32	11	10
T40H	8	32	12	10
T45H	8	32	12	10
T50H	8	32	12	10
T55H	8	32	12	10

100X-32	D (mm)	L (mm)	(g)	(pcs.)
M 5	8	32	10	10
M 6	8	32	11	10
M 8	8	32	12	10
M10	8	32	16	10
M12	8	32	19	10

		D <sub>1</sub> (mm)	D <sub>2</sub> (mm)	L (mm)	(g)	(pcs.)
2138	1/4"	16	16	26	32	10
3138	3/8"	16	18	38	55	10
4138	1/2"	16	22	38	62	10

For DIN3126 C8 Bits  
Für DIN3126 C8 Bits  
Pour DIN3126 C8 Embouts

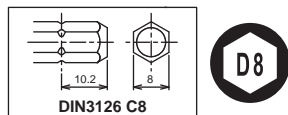

## 100T-32 (TH)

Tamper-Resistant TORX® Bits  
Tamper-Resistant TORX® Bits  
Embouts TORX®, Tamper-Resistant



Tamper Resistant TORX® Bits have less strength due to special design.  
Make sure to use it correctly.

## 100X-32 (XZN)

XZN Bits  
XZN Bits  
Embouts, XZN



## 2138

Bit Holder  
Klingenhalter  
Porte-embouts

## 3138

## 4138

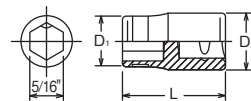

## 12140

## 13140

## 14140

Impact Bit Holder  
Impact Klingenhalter  
Porte embouts Impact

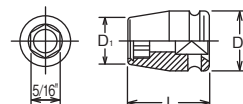

		D <sub>1</sub> (mm)	D <sub>2</sub> (mm)	L (mm)	(g)	(pcs.)	
12140	1/4"	14	13	25	15	10	*1
13140	3/8"	14	19	30	32	10	*2
14140	1/2"	14	25	35	62	10	*3

\*1 Pin/O-Ring=1200A/B  
\*2 C-Ring=1301C, Pin/O-Ring=1301A/B  
\*3 C-Ring=1401C, Pin/O-Ring=1401A/B

For DIN3126 C8 Bits  
Für DIN3126 C8 Bits  
Pour DIN3126 C8 Embouts

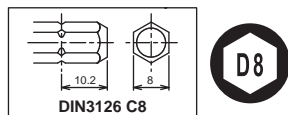

	D (mm)	H (mm)	L (mm)	(g)	(pcs.)
2749P-5/16HF	25	14	125	96	10
2774P-5/16HF	25	14	165	133	2

For DIN3126 C8 Bits  
Für DIN3126 C8 Bits  
Pour DIN3126 C8 Embouts

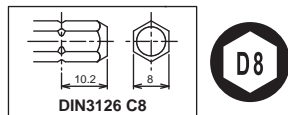

## 2749P-5/16HF

Reversible Ratchet, for Bits 5/16"  
Knarre, verstellbar für Bits 5/16"  
Cliquet, réversible pour embouts 5/16"

## 2774P-5/16HF

Flexible Ratchet, reversible, for Bits 5/16"  
Gelenk-Knarre, verstellbar, für Bits 5/16"  
Cliquet à tête articulée pour embouts 5/16"

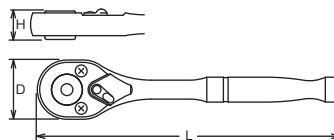

**121P-50 / -70 / -100 / -150**  PH Bits  
PH Bits  
Embouts, PH

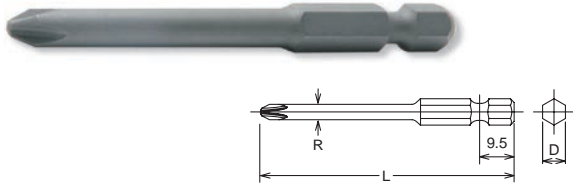

121P-50 (PH)	D (mm)	R (mm)	L (mm)	(g)	(pcs.)
1	6.35	4.5	50	12	10
2	6.35	5.5	50	12	10
3	6.35	-	50	13	10

121P-70 (PH)	D (mm)	R (mm)	L (mm)	(g)	(pcs.)
1	6.35	4.5	70	15	10
2	6.35	5.5	70	15	10
3	6.35	-	70	16	10

121P-100 (PH)	D (mm)	R (mm)	L (mm)	(g)	(pcs.)
1	6.35	4.5	100	23	10
2	6.35	5.5	100	23	10
3	6.35	-	100	24	10

121P-150 (PH)	D (mm)	R (mm)	L (mm)	(g)	(pcs.)
1	6.35	4.5	150	30	10
2	6.35	5.5	150	35	10
3	6.35	-	150	36	10

**121H-50 / -70 / -100 / -150**  Hex Bits  
Sechskant Bits  
Embouts, 6 pans creux

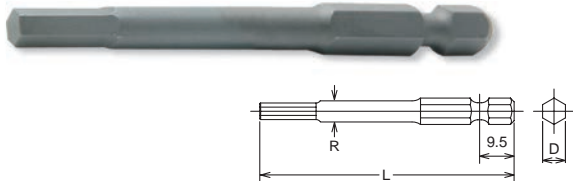

121H-50 (mm)	D (mm)	R (mm)	L (mm)	(g)	(pcs.)
2	6.35	3	50	11	10
2.5	6.35	3	50	12	10
3	6.35	3.5	50	12	10
4	6.35	4.5	50	12	10
5	6.35	5.6	50	13	10
6	6.35	-	50	14	10

121H-70 (mm)	D (mm)	R (mm)	L (mm)	(g)	(pcs.)
2	6.35	3	70	13	10
2.5	6.35	3	70	15	10
3	6.35	3.5	70	15	10
4	6.35	4.5	70	15	10
5	6.35	5.6	70	16	10
6	6.35	-	70	18	10

121H-100 (mm)	D (mm)	R (mm)	L (mm)	(g)	(pcs.)
2	6.35	3	100	22	10
2.5	6.35	3	100	23	10
3	6.35	3.5	100	23	10
4	6.35	4.5	100	23	10
5	6.35	5.6	100	24	10
6	6.35	-	100	26	10

121H-150 (mm)	D (mm)	R (mm)	L (mm)	(g)	(pcs.)
2	6.35	3.5	150	35	10
2.5	6.35	3.5	150	35	10
3	6.35	3.5	150	37	10
4	6.35	4.5	150	37	10
5	6.35	5.6	150	38	10
6	6.35	-	150	39	10

**121T-50 / -70 / -100 / -150 (T)**  TORX® Bits  
TORX® Bits  
Embouts, TORX®

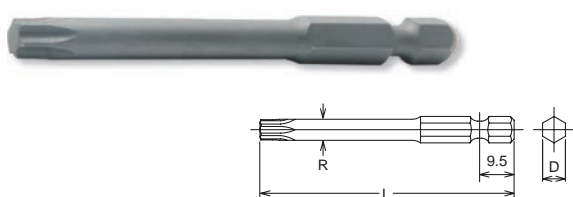

121T-50 (T)	D (mm)	R (mm)	L (mm)	(g)	(pcs.)
T10	6.35	3	50	12	10
T15	6.35	3.5	50	12	10
T20	6.35	4.1	50	12	10
T25	6.35	4.6	50	12	10
T27	6.35	5.2	50	13	10
T30	6.35	5.7	50	13	10
T40	6.35	-	50	14	10

121T-70 (T)	D (mm)	R (mm)	L (mm)	(g)	(pcs.)
T10	6.35	3.5	70	16	10
T15	6.35	3.5	70	16	10
T20	6.35	4.1	70	16	10
T25	6.35	4.6	70	16	10
T27	6.35	5.2	70	17	10
T30	6.35	5.7	70	17	10
T40	6.35	-	70	18	10

121T-100 (T)	D (mm)	R (mm)	L (mm)	(g)	(pcs.)
T10	6.35	3.5	100	24	10
T15	6.35	3.5	100	24	10
T20	6.35	4.1	100	24	10
T25	6.35	4.6	100	24	10
T27	6.35	5.2	100	24	10
T30	6.35	5.7	100	25	10
T40	6.35	-	100	26	10

121T-150 (T)	D (mm)	R (mm)	L (mm)	(g)	(pcs.)
T10	6.35	3.5	150	35	10
T15	6.35	3.5	150	37	10
T20	6.35	4.1	150	37	10
T25	6.35	4.6	150	37	10
T27	6.35	5.2	150	37	10
T30	6.35	5.7	150	38	10
T40	6.35	-	150	39	10

121T-70 (TH)	D (mm)	R (mm)	L (mm)	(g)	(pcs.)
T15H	6.35	3.5	70	15	10
T20H	6.35	4.1	70	16	10
T25H	6.35	4.6	70	16	10
T27H	6.35	5.2	70	17	10
T30H	6.35	5.7	70	17	10
T40H	6.35	-	70	18	10

121T-100 (TH)	D (mm)	R (mm)	L (mm)	(g)	(pcs.)
T15H	6.35	3.5	100	22	10
T20H	6.35	4.1	100	24	10
T25H	6.35	4.6	100	24	10
T27H	6.35	5.2	100	24	10
T30H	6.35	5.7	100	25	10
T40H	6.35	-	100	26	10

**⚠** Tamper Resistant TORX® Bits have less strength due to special design. Make sure to use it correctly.

121T-50 (IP)	D (mm)	R (mm)	L (mm)	(g)	(pcs.)
20IP	6.35	4.1	50	12	10
25IP	6.35	4.6	50	12	10
27IP	6.35	5.2	50	13	10
30IP	6.35	5.7	50	13	10
40IP	6.35	-	50	14	10

121T-70 (IP)	D (mm)	R (mm)	L (mm)	(g)	(pcs.)
20IP	6.35	4.1	70	16	10
25IP	6.35	4.6	70	16	10
27IP	6.35	5.2	70	17	10
30IP	6.35	5.7	70	17	10
40IP	6.35	-	70	18	10

	□	D <sub>1</sub> (mm)	D <sub>2</sub> (mm)	L (mm)	(g)	(pcs.)	⚡
12137E	1/4"	12	13	36	22	10	*1
13137E	3/8"	12	19	40	40	10	*2
14137E	1/2"	12	25	48	70	10	*3

\*1 Pin/O-Ring=1200A/B  
 \*2 C-Ring=1301C, Pin/O-Ring=1301A/B  
 \*3 C-Ring=1401C, Pin/O-Ring=1401A/B

→ P254-255

For DIN3126 E6.3 Bits  
 Für DIN3126 E6.3 Bits  
 Pour DIN3126 E6.3 Embouts

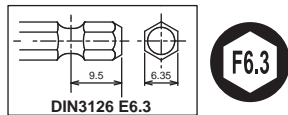

12137E, 13137E and 14147E can be used with various 1/4" bits, DIN 3126-C6.3, DIN 3126-E6.3 and Double ended type.

Die neuen Bithalter können für alle 1/4" Bits DIN 3126-C6.3, DIN 3126-E6.3 und für doppelseitige Bits verwendet werden.

Ces nouveaux porte embouts peuvent être utilisés avec tous les embouts 1/4" DIN 3126 E-6.3 et DIN 3126 C6.3

	□	D <sub>1</sub> (mm)	D <sub>2</sub> (mm)	L (mm)	(g)	(pcs.)	⚡
12142-F6.3	1/4"	16.5	13	40	22	10	*1
13142-F6.3	3/8"	16.5	19	45	60	10	*2
14142-F6.3	1/2"	16.5	25	55	100	10	*3

\*1 Pin/O-Ring=1200A/B  
 \*2 C-Ring=1301C, Pin/O-Ring=1301A/B  
 \*3 C-Ring=1401C, Pin/O-Ring=1401A/B

→ P254-255

For DIN3126 E6.3 Bits  
 Für DIN3126 E6.3 Bits  
 Pour DIN3126 E6.3 Embouts

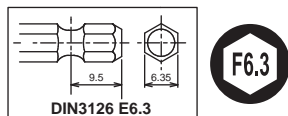

**Lock & Quick Release**

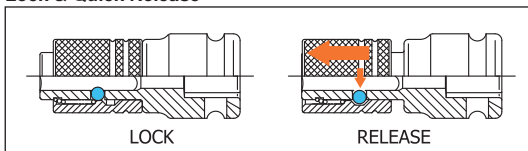

**⚠** You may not hold the sliding part while moving to avoid heating up by friction and reduction by wear.

TORXplus is a registered trademark of Acument Intellectual Properties, LLC.  
 TORXplus ist ein registriertes Markenzeichen der Firma Acument Intellectual Properties, LLC.  
 TORXplus est une marque déposée de Acument Intellectual Properties, LLC.

## 121T-70 / -100 (TH)

**⚠** Tamper-Resistant TORX® Bits  
 Tamper-Resistant TORX® Bits  
 Embouts TORX®, Tamper-Resistant

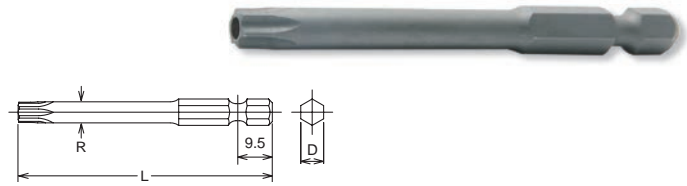

## 121T-50 / -70 (IP)

**⚠** TORXPLUS® Bits  
 TORXPLUS® Bits  
 Embouts TORXPLUS®

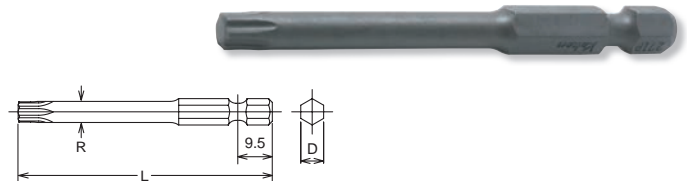

## 12137E 13137E 14137E

**⚠** Impact Bit Holder  
 Impact Klingenhalter  
 Porte embouts Impact



## 12142-F6.3 13142-F6.3 14142-F6.3

**⚠** Impact Bit Holder (Quick Release)  
 Impact Klingenhalter (Quick Release)  
 Porte embouts Impact (Quick Release)



### 123PT-75 / -100

⊕ Double ended Torsion Bits, Phillips  
Doppelseitige Torsionsbits, Phillips  
Emboutis torsion double face, Phillips

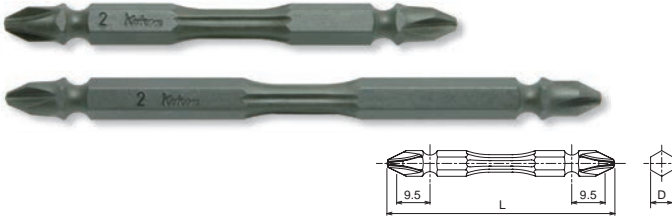

123PT (PH)	D (mm)	L (mm)	(g)	(pcs.)
2	6.35	75	18	10
2	6.35	100	24	10

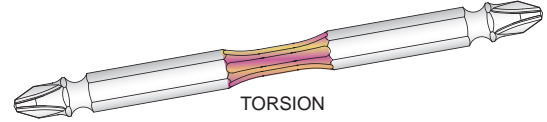

### 123PN-75 / -100

⊕ Double ended Bits, Phillips  
Doppelseitige bits, Phillips  
Emboutis double face, Phillips

### 123PG-75 / -100

⊕ Magnetic type  
Magnetisch  
Type magnétique

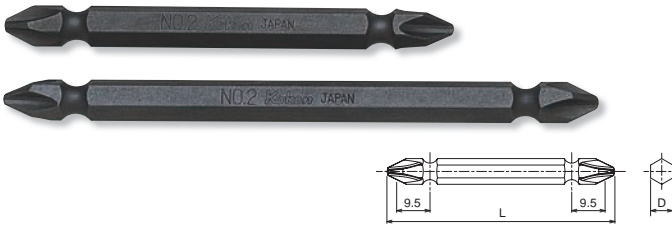

123PN.75 123PG.75 (PH)	D (mm)	L (mm)	(g)	(pcs.)
1	6.35	75	16	10
2	6.35	75	16	10
3	6.35	75	17	10

123PN.100 123PG.100 (PH)	D (mm)	L (mm)	(g)	(pcs.)
1	6.35	100	23	10
2	6.35	100	23	10
3	6.35	100	24	10

### 165LM

○ Slide Socket with Magnet  
Gleitsteckschlüssel mit Magnet  
Clé à douille coulissante avec aimant

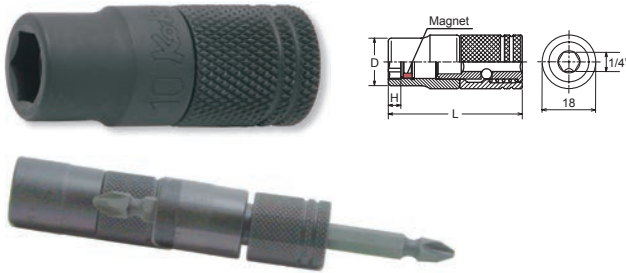

165LM.45 (mm)	D (mm)	H (mm)	L (mm)	(g)	(pcs.)
8	13.5	3.5	45	55	10
10	16	4.2	45	58	10
12	18.5	5.6	45	65	10
13	20	6	45	68	10
14	21	6.4	45	70	10

Slide the socket by pulling holder, and pull back the socket to lock on the bit groove. Ring magnet holds a bolt or nut for easy work.

Schieben Sie den Gleitsteckschlüssel durch Ziehen an der Hülse des Halters. Ziehen Sie das Werkzeug soweit zurück bis es sich in der Nut des Bits verriegelt. Zur Arbeitserleichterung hält der Ringmagnet die Schraube bzw. die Mutter.

Poussez la clé à douille coulissante en tirant sur le support. Tirez l'outil vers l'arrière jusqu'à ce qu'il s'enclenche dans la rainure de la meche. L'aimant maintient la vis ou l'ecrou pour faciliter le travail.

⚠ You may not hold the sliding part while moving to avoid heating up by friction and reduction by wear.

Sie dürfen das Gleiteil nicht während der Bewegung halten, um Erwärmung durch Reibung und unnötigen Verschleiss zu vermeiden.

Ne pas tenir la partie coulissante pendant le mouvement pour éviter l'échauffement du au frottement et à l'usure inutile.

⚠ Please handle with care. The magnet could be broken with any impacts.

Der Magnet kann durch Stöße beschädigt werden. Bitte gehen Sie vorsichtig vor.

L'aimant peut être endommagé par des chocs importants. Veuillez procéder avec précaution.

#### Nut Setter

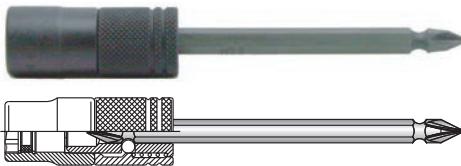

#### Phillips Bit

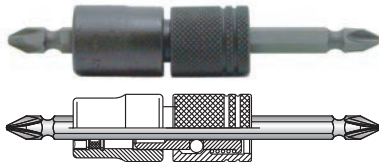

### 165BM

○ Double-sided sliding socket wrench with side magnets  
Doppelseitiger Schiebsteckschlüssel mit Seitenmagneten  
Clé à douille double face, coulissante avec aimants latéraux

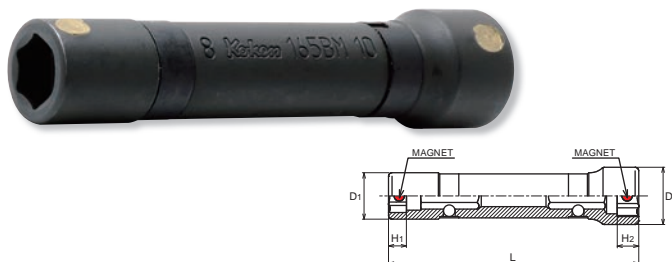

165BM.70 (mm)	D <sub>1</sub> (mm)	D <sub>2</sub> (mm)	H <sub>1</sub> (mm)	H <sub>2</sub> (mm)	L (mm)	(g)	(pcs.)
<b>New</b> 8x10	13	16	5	6	70	55	10

165BM.80 (mm)	D <sub>1</sub> (mm)	D <sub>2</sub> (mm)	H <sub>1</sub> (mm)	H <sub>2</sub> (mm)	L (mm)	(g)	(pcs.)
<b>New</b> 10x12	16	19.1	6	8	80	80	10



## 113-50

Nut Setters  
Steckschlüssel Klingen  
Embouts pour écrous

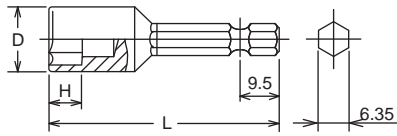

113-50 (mm)	D (mm)	H (mm)	L (mm)	(g)	(pcs.)
5.5	9	4	50	15	10
6	10	5	50	17	10
7	11	5	50	19	10
8	12	6	50	20	10
10	14.2	7	50	31	10
12	17	8	50	39	10
13	18	8	50	42	10
14	19	9	50	46	10

113-50 (inch)	D (mm)	H (mm)	L (mm)	(g)	(pcs.)
1/4	10	5	50	17	10
5/16	12	6	50	20	10
3/8	14.2	7	50	31	10
1/2	18	8	50	42	10

## 113-75 / -100 / -150 / -200 / -250

Nut Setters  
Steckschlüssel Klingen  
Embouts pour écrous

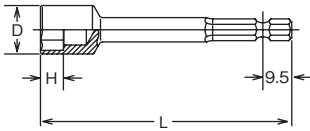

113-75 (mm)	D (mm)	H (mm)	L (mm)	(g)	(pcs.)
7	11.5	5	75	31	10
8	12.7	6	75	32	10
10	14.5	7	75	35	10
12	17	8	75	42	10
13	18	8	75	41	10
14	19	9	75	43	10

113-100 (mm)	D (mm)	H (mm)	L (mm)	(g)	(pcs.)
7	11.5	5	100	40	10
8	12.7	6	100	41	10
10	14.5	7	100	45	10
12	17	8	100	52	10
13	18	8	100	51	10
14	19	9	100	53	10

113-150 (mm)	D (mm)	H (mm)	L (mm)	(g)	(pcs.)
7	11.5	5	150	59	10
8	12.7	6	150	60	10
10	14.5	7	150	64	10
12	17	8	150	70	10
13	18	8	150	76	10
14	19	9	150	78	10

113-200 (mm)	D (mm)	H (mm)	L (mm)	(g)	(pcs.)
7	11.5	5	200	78	10
8	12.7	6	200	79	10
10	14.5	7	200	83	10
12	17	8	200	91	10
13	18	8	200	93	10
14	19	9	200	95	10

113-250 (mm)	D (mm)	H (mm)	L (mm)	(g)	(pcs.)
7	11.5	5	250	99	10
8	12.7	6	250	100	10
10	14.5	7	250	105	10
12	17	8	250	113	10
13	18	8	250	114	10
14	19	9	250	119	10

113-50 (E)	D (mm)	H (mm)	L (mm)	(g)	(pcs.)
E 4	6.1	4.5	50	12	10
E 5	7.5	4.5	50	15	10
E 6	8.3	5.0	50	17	10
E 7	8.8	5.8	50	18	10
E 8	10.1	6.6	50	19	10
E10	12	7.4	50	20	10

## 113-50 (E)

Nut Setters, TORX®  
Steckschlüssel Klingen, TORX®  
Embouts pour écrous, TORX®

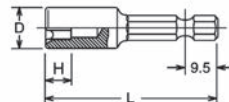

113-50 (mm)	D (mm)	H (mm)	L (mm)	(g)	(pcs.)
7(2B)	11	5	50	20	10
8(2B)	12	6	50	21	10
10(2B)	14.2	7	50	26	10
13(2B)	18	8	50	31	10



## 113-50 (2B)

Nut Setters, with 2 Balls  
Steckschlüssel Klingen, mit 2-facher Kugelhalterung  
Douilles à billes de retenue  
**Nut Grip®**

113-50 (inch)	D (mm)	H (mm)	L (mm)	(g)	(pcs.)
3/8(2B)	14.2	7	50	26	10

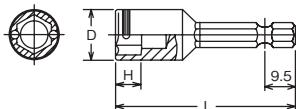

Z-SERIES  
HAND  
TITANIUM  
ACCESSORIES  
SCREWDRIVERS  
IMPACT  
SLEEVE-DRIVE  
PROTECTOR  
INDUSTRIAL  
AUTOMOTIVE  
MOTORCYCLE  
CONSTRUCTION  
SPARE PART

**115-50**  Nut Setters with Magnet  
Steckschlüssel Klingen mit Magnet  
Embouts avec aimant pour écrous

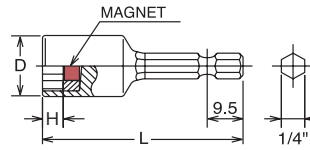

115-50 (mm)	D (mm)	H (mm)	L (mm)	(g)	(pcs.)
5.5	9	2.1	50	15	10
6	10	2.4	50	17	10
7	11	2.8	50	19	10
8	12	3.5	50	20	10
10	14.2	4.2	50	29	10
12	17	5.6	50	40	10
13	18	6	50	50	10
14	19	6.4	50	60	10

115-50 (inch)	D (mm)	H (mm)	L (mm)	(g)	(pcs.)
1/4	10	2.4	50	17	10
5/16	12	3.5	50	20	10
3/8	14.2	4.2	50	29	10
1/2	18	6	50	50	10

**115-75 / -100 / -150 / -200 / -250** 

Nut Setters with Magnet  
Steckschlüssel Klingen mit Magnet  
Embouts avec aimant pour écrous

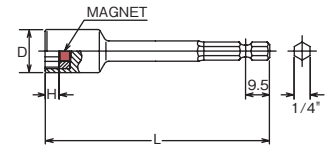

115-75 (mm)	D (mm)	H (mm)	L (mm)	(g)	(pcs.)
7	11.5	2.8	75	32	10
8	12.7	3.5	75	33	10
10	14.5	4.2	75	38	10
12	17	5.6	75	46	10
13	18	6	75	49	10
14	19	6.4	75	52	10

115-100 (mm)	D (mm)	H (mm)	L (mm)	(g)	(pcs.)
7	11.5	2.8	100	41	10
8	12.7	3.5	100	42	10
10	14.5	4.2	100	50	10
12	17	5.6	100	58	10
13	18	6	100	62	10
14	19	6.4	100	65	10

115-150 (mm)	D (mm)	H (mm)	L (mm)	(g)	(pcs.)
7	11.5	2.8	150	60	10
8	12.7	3.5	150	61	10
10	14.5	4.2	150	68	10
12	17	5.6	150	77	10
13	18	6	150	82	10
14	19	6.4	150	85	10

115-200 (mm)	D (mm)	H (mm)	L (mm)	(g)	(pcs.)
7	11.5	2.8	200	79	10
8	12.7	3.5	200	80	10
10	14.5	4.2	200	88	10
12	17	5.6	200	97	10
13	18	6	200	102	10
14	19	6.4	200	105	10

115-250 (mm)	D (mm)	H (mm)	L (mm)	(g)	(pcs.)
7	11.5	2.8	250	101	10
8	12.7	3.5	250	103	10
10	14.5	4.2	250	110	10
12	17	5.6	250	118	10
13	18	6	250	122	10
14	19	6.4	250	124	10



## 113UN-100 / -150 / -200

6-point Universal Joint Nut Setters  
6-kant Steckschlüsselklingen mit Gelenk  
Douilles 6-pans articulées à embout



113UN-100 (mm)	D (mm)	H (mm)	L (mm)	(g)	(pcs.)
8	13	7	100	50	10
10	15	8	100	53	10
12	17	10	100	56	10
13	18	10	100	65	10
14	19.2	10	100	67	10

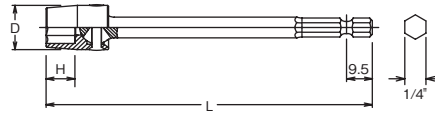

113UN-150 (mm)	D (mm)	H (mm)	L (mm)	(g)	(pcs.)
8	13	7	150	65	10
10	15	8	150	70	10
12	17	10	150	77	10
13	18	10	150	92	10
14	19.2	10	150	92	10

113UN-200 (mm)	D (mm)	H (mm)	L (mm)	(g)	(pcs.)
8	13	7	200	75	10
10	15	8	200	87	10
12	17	10	200	98	10
13	18	10	200	116	10
14	19.2	10	200	116	10

## 115G-75 / -100 / -150 / -200 / -250

Nut Setters with sliding Magnet  
Steckschlüssel Klingen mit versenkbarem Magnet  
Embouts avec aimant, glissant pour écrous



115G-75 (mm)	D (mm)	H <sub>1</sub> (mm)	H <sub>2</sub> (mm)	L (mm)	(g)	(pcs.)
7	11.5	3.5	26	75	34	10
8	12.7	4	26	75	41	10
10	14.5	4.5	26	75	48	10
12	17	6	26	75	65	10
13	18	6.5	25	75	70	10
14	19	7	24	75	73	10

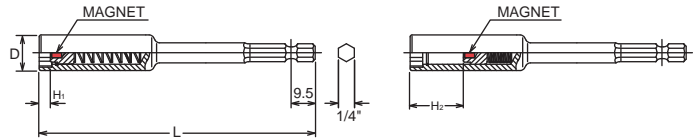

115G-150 (mm)	D (mm)	H <sub>1</sub> (mm)	H <sub>2</sub> (mm)	L (mm)	(g)	(pcs.)
7	11.5	3.5	26	150	67	10
8	12.7	4	26	150	70	10
10	14.5	4.5	26	150	77	10
12	17	6	26	150	95	10
13	18	6.5	25	150	100	10
14	19	7	24	150	105	10

115G-100 (mm)	D (mm)	H <sub>1</sub> (mm)	H <sub>2</sub> (mm)	L (mm)	(g)	(pcs.)
7	11.5	3.5	26	100	51	10
8	12.7	4	26	100	51	10
10	14.5	4.5	26	100	57	10
12	17	6	26	100	77	10
13	18	6.5	25	100	80	10
14	19	7	24	100	82	10

115G-250 (mm)	D (mm)	H <sub>1</sub> (mm)	H <sub>2</sub> (mm)	L (mm)	(g)	(pcs.)
8	12.7	4	26	250	110	10
10	14.5	4.5	26	250	120	10
12	17	6	26	250	130	10
13	18	6.5	25	250	150	10

115G-200 (mm)	D (mm)	H <sub>1</sub> (mm)	H <sub>2</sub> (mm)	L (mm)	(g)	(pcs.)
7	11.5	3.5	26	200	86	10
8	12.7	4	26	200	89	10
10	14.5	4.5	26	200	96	10
12	17	6	26	200	119	10
13	18	6.5	25	200	125	10
14	19	7	24	200	128	10

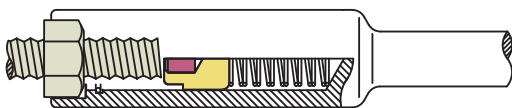

Sliding magnet system provides bolt clearance and magnetic function at the same time. The item 115G is mainly designed for assembly line work.

Die Steckschlüsselklinge mit versenkbarem Magnet bietet die Funktion eines Haltemagneten und genügend Freiraum für überstehende Bolzen. Dieses Werkzeug eignet sich vor allem für Montagearbeiten.

L'embout avec aimant glissant offre une fonction d'aimant et laisse assez d'espace pour des goujons surmontés. L'objet 115G a été conçu spécialement pour le travail d'assemblage.

119 (mm)	D (mm)	H (mm)	L (mm)	(g)	(pcs.)
5.5	9	2.1	50	17	10
6	10	2.4	50	20	10
7	11	2.8	50	22	10
8	12	3.5	50	23	10
10	14.2	4.2	50	30	10
12	17	5.6	50	42	10
13	18	6	50	52	10

119 Nut Setters with Magnet  
Steckschlüssel Klingen mit Magnet  
Embouts avec aimant pour écrous

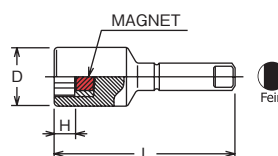

119 (inch)	D (mm)	H (mm)	L (mm)	(g)	(pcs.)
1/4	10	1.8	50	20	10
5/16	12	3.5	50	23	10
3/8	14.2	4.2	50	30	10

Z-SERIES  
HAND  
TITANIUM  
SCREWDRIVERS ACCESSORIES  
IMPACT  
SLEEVE-DRIVE  
PROTECTOR  
INDUSTRIAL  
AUTOMOTIVE  
MOTORCYCLE  
CONSTRUCTION  
SPARE PART

## 183H-35 / -75 / -150

Hex Bits  
Sechskant Bits  
Embout, 6 pans creux

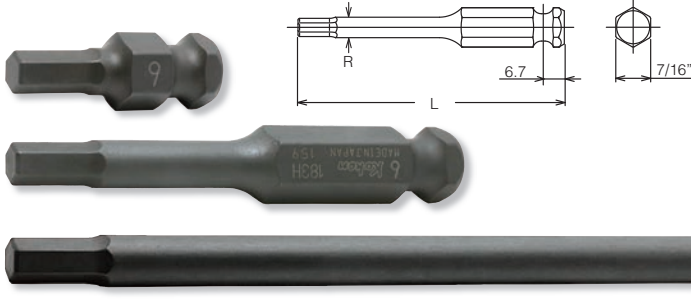

183H-35 (inch)	L (mm)	(g)	(pcs.)
3/16	35	15	10
7/32	35	16	10
1/4	35	18	10
5/16	35	20	10
3/8	35	26	10
7/16	35	28	10
1/2	35	38	10

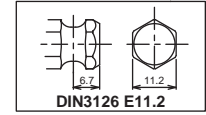

183H-35 (mm)	L (mm)	(g)	(pcs.)
3	35	15	10
4	35	15	10
5	35	15	10
6	35	18	10
7	35	19	10
8	35	20	10
New 9	35	23	10
10	35	26	10
11	35	28	10
12	35	30	10
14	35	35	10
16	35	47	10
17	35	50	10
18	35	53	10
19	35	56	10

183H-75 (mm)	L (mm)	R (mm)	(g)	(pcs.)
3	75	6	34	10
4	75	6	35	10
5	75	6.5	36	10
6	75	7.5	39	10
7	75	8.5	44	10
8	75	9.5	47	10
10	75	-	57	10
11	75	-	60	10
12	75	-	65	10
14	75	-	79	10

183H-150 (mm)	L (mm)	R (mm)	(g)	(pcs.)
4	150	6	51	10
5	150	6.5	55	10
6	150	7.5	65	10
8	150	9.5	87	10
10	150	-	118	10
12	150	-	136	10

## 183T-35 / -75 / -150 (T)

TORX® Bits  
TORX® Bits  
Embout, TORX®

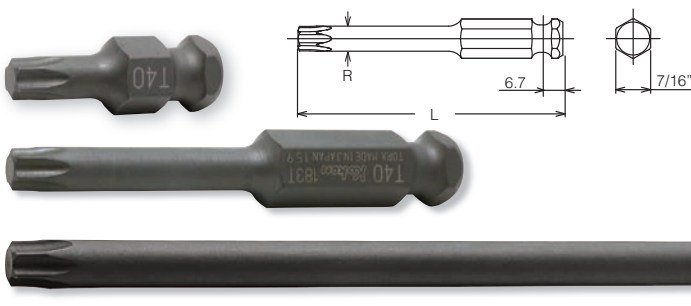

183T-35 (T)	L (mm)	(g)	(pcs.)
T25	35	18	10
T30	35	18	10
T40	35	20	10
T45	35	22	10
T50	35	26	10
T55	35	30	10
T60	35	38	10

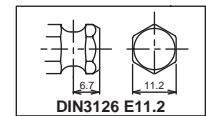

183T-75 (T)	L (mm)	R (mm)	(g)	(pcs.)
T30	75	6	35	10
T40	75	6.9	37	10
T45	75	8	41	10
T50	75	9	45	10
T55	75	11.4	55	10
T60	75	13.5	67	10

183T-150 (T)	L (mm)	R (mm)	(g)	(pcs.)
T30	150	6	50	10
T40	150	6.9	58	10
T45	150	8	70	10
T50	150	9	82	10
T55	150	11.4	113	10

## 183T-35 / -75 (IP)

TORXPLUS® Bits  
TORXPLUS® Bits  
Embout TORXPLUS®

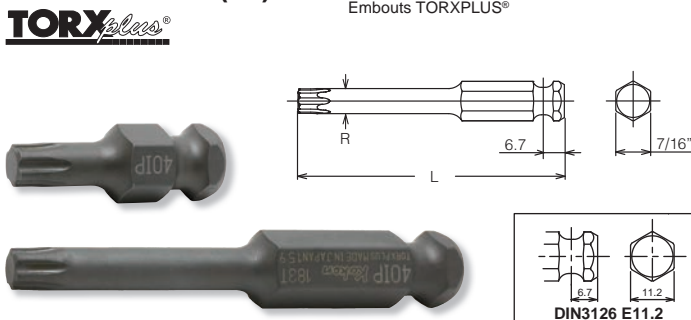

183T-35 (IP)	L (mm)	(g)	(pcs.)
30IP	35	18	10
40IP	35	20	10
45IP	35	22	10
50IP	35	26	10
55IP	35	30	10
60IP	35	38	10

183T-75 (IP)	L (mm)	R (mm)	(g)	(pcs.)
30IP	75	6	35	10
40IP	75	6.8	37	10
45IP	75	8	41	10
50IP	75	9	45	10
55IP	75	11.4	56	10
60IP	75	13.5	67	10

183X-35 (XZN)	L (mm)	(g)	(pcs.)
M 4	35	18	10
M 5	35	18	10
M 6	35	20	10
M 8	35	22	10
M10	35	26	10
M12	35	30	10
M14	35	38	10

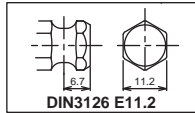

## 183X-35 / -75 / -150 (XZN)

XZN Bits  
XZN Bits  
Embouts, XZN

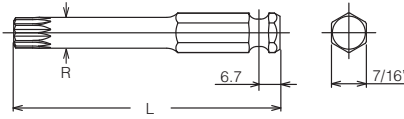

183X-75 (XZN)	L (mm)	R (mm)	(g)	(pcs.)
M 4	75	6	34	10
M 5	75	6	34	10
M 6	75	6.2	36	10
M 8	75	7.4	39	10
M10	75	9.8	54	10
M12	75	11.7	57	10
M14	75	13.5	67	10

183X-150 (XZN)	L (mm)	R (mm)	(g)	(pcs.)
M 5	150	6	50	10
M 6	150	6.2	53	10
M 8	150	7.4	64	10
M10	150	9.8	93	10
M12	150	11.7	121	10

		D (mm)	L (mm)	(g)	(pcs.)	
13134	3/8"	22	32	70	10	*1
14134	1/2"	25	38	90	10	*2
16134	3/4"	44	52	200	2	*3

\*1 C-Ring=1302C, Pin/O-Ring=1302A/B  
\*2 C-Ring=1401C, Pin/O-Ring=1401A/B  
\*3 C-Ring=1600C, Pin/O-Ring=1601A/B

→ P254-255

For DIN3126 E11.2 Bits  
Für DIN3126 E11.2 Bits  
Pour DIN3126 E11.2 Embouts

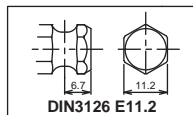

### 13134-SC

Replacement Screw : M8x5, ● 4mm  
Ersatzschraube : M8x5, ● 4mm  
Vis de remplacement : M8x5, ● 4mm

		D <sub>1</sub> (mm)	D <sub>2</sub> (mm)	L (mm)	(g)	(pcs.)	
13142-F11.2	3/8"	18.9	22	46	116	10	*1
14142-F11.2	1/2"	18.9	25	46	207	10	*2

\*1 C-Ring=1302C, Pin/O-Ring=1302A/B  
\*2 C-Ring=1401C, Pin/O-Ring=1401A/B

→ P254-255

For DIN3126 E11.2 Bits  
Für DIN3126 E11.2 Bits  
Pour DIN3126 E11.2 Embouts

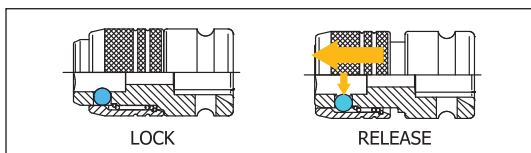
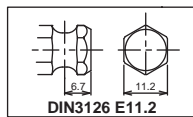

## 13134 14134 16134

Impact Bit Holder  
Impact Klingenhalter  
Porte embouts Impact

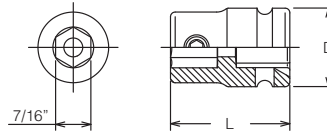

## 13142-F11.2 14142-F11.2

Impact Bit Holder (Quick Release)  
Impact Klingenhalter (Quick Release)  
Porte embouts Impact (Quick Release)

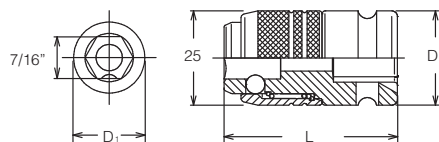



Adaptors with male Square  
Verbindungssteile mit Aussenvierkant  
Adaptateurs avec carré mâle

Z-SERIES

HAND

TITANIUM

ACCESSORIES

SCREWDRIVERS

IMPACT

SLEEVE-DRIVE

PROTECTOR

INDUSTRIAL

AUTOMOTIVE

MOTORCYCLE

CONSTRUCTION

SPARE PART

**110-35B / -50B / -100B / -150B  
-35P / -50P / -100P / -150P**

Adaptors  
Verbindungsstücke  
Adaptateurs

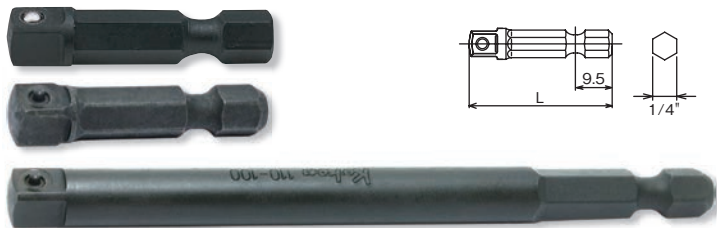

110		TYPE	L (mm)	(g)	(pcs.)
35B	1/4"	Ball	35	9	10
35P		Pin	35	9	10
50B		Ball	50	15	10
50P		Pin	50	15	10
100B		Ball	100	34	10
100P		Pin	100	34	10
150B	Ball	150	54	10	
150P	Pin	150	54	10	

● DIN 3126 Form E 6.3

**112-50B / -100B / -150B  
-50P / -100P / -150P**

Adaptors  
Verbindungsstücke  
Adaptateurs

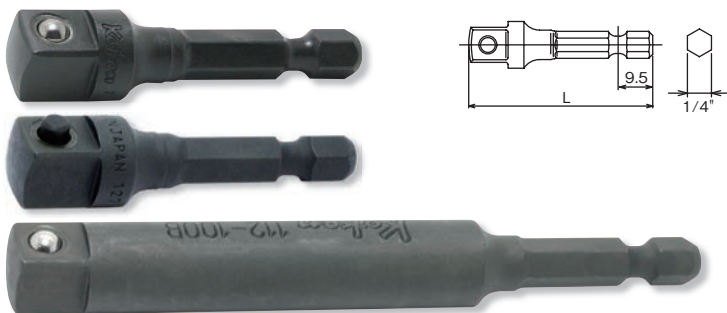

112		TYPE	L (mm)	(g)	(pcs.)
50B	3/8"	Ball	50	22	10
50P		Pin	50	22	10
100B		Ball	100	71	10
100P		Pin	100	71	10
150B		Ball	150	121	10
150P		Pin	150	121	10

● DIN 3126 Form E 6.3

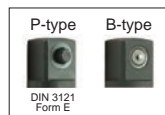

**135E-60B / -60P**

Adaptor  
Verbindungsstück  
Adaptateurs

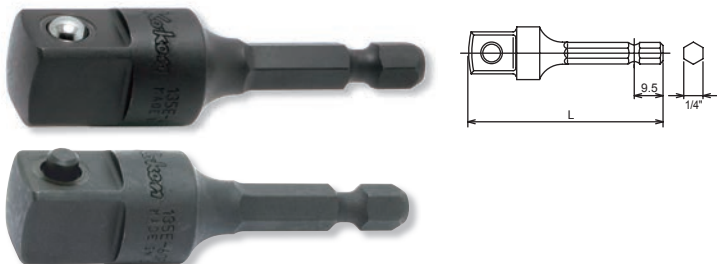

135E		TYPE	L (mm)	(g)	(pcs.)
60B	1/2"	Ball	60	46	10
60P		Pin	60	46	10

● DIN 3126 Form E 6.3

**117-50B / -100B  
-50P / -100P**

Adaptors  
Verbindungsstücke  
Adaptateurs



117		TYPE	L (mm)	(g)	(pcs.)
50B	1/4"	Ball	50	15	10
50P		Pin	50	15	10
100B		Ball	100	71	10
100P		Pin	100	71	10

● DIN 3126 Form G7

**120-50B / -50P**

Adaptor  
Verbindungsstück  
Adaptateurs

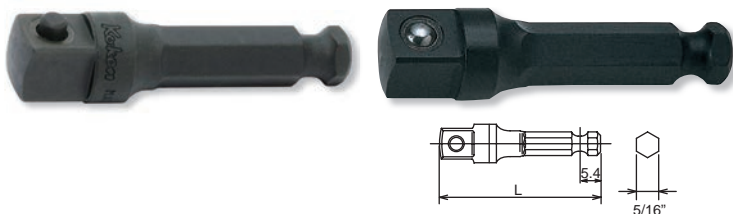

120		TYPE	L (mm)	(g)	(pcs.)
50B	3/8"	Ball	50	27	10
50P		Pin	50	27	10

● DIN 3126 Form E 8

**186-75P**

Adaptor  
Verbindungsstück  
Adaptateurs

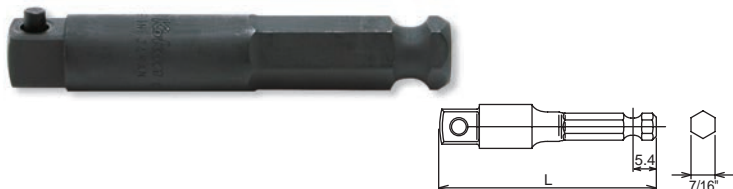

186		L (mm)	(g)	(pcs.)
75P	3/8"	75	65	10
75P	1/2"	75	85	10

● DIN 3126 Form E 11.2